

Lewes District Council
BYELAWS FOR PLEASURE GROUNDS, PUBLIC WALKS
AND OPEN SPACES

ARRANGEMENT OF BYELAWS

PART 1
GENERAL

- 1 General Interpretation
- 2 Application
- 3 Opening Times

PART 2

PROTECTION OF THE GROUND, ITS WILDLIFE AND THE PUBLIC

- 4 Protection of structures and plants
- 5 Unauthorised erection of structures
- 6 Grazing
- 7 Protection of wildlife
- 8 Camping
- 9 Fires
- 10 Missiles
- 11 Interference with life-saving equipment

PART 3

HORSES, CYCLES AND VEHICLES

- 12 Interpretation of Part 3
- 13 Horses
- 14 Cycling
- 15 Motor vehicles
- 16 Overnight parking

PART 4

PLAY AREAS, GAMES AND SPORTS

- 17 Interpretation of Part 4
- 18 Children's play areas
- 19 Children's play apparatus
- 20 Skateboarding etc
- 21 Ball games
- 22 Ball games outside designated areas

- 23 Ball games within designated areas
- 24 Cricket
- 25 Archery
- 26 Field sports
- 27 Golf

PART 5 WATERWAYS

- 28 Interpretation of Part 5
- 29 Pollution of waterways
- 30 Blocking of watercourses

PART 6 MODEL AIRCRAFT

- 31 Interpretation of Part 6
- 32 General prohibition

PART 7 OTHER REGULATED ACTIVITIES

- 33 Trading
- 34 Excessive noise
- 35 Public shows and performances
- 36 Aircraft, hang-gliders and hot-air balloons
- 37 Kites
- 38 Metal detectors

PART 8 MISCELLANEOUS

- 39 Obstruction
- 40 Savings
- 42 Removal of offenders
- 43 Penalty
- 44 Revocation

SCHEDULE 1 List of Grounds

**PART A
PART B
PART C
PART D
PART E**

SCHEDULE 2
Rules for Playing Ball Games in Designated Areas

Byelaws made under section 164 of the Public Health Act 1875 and sections 12 and 15 of the Open Spaces Act 1906 by the Council of the District of Lewes with respect to pleasure grounds, public walks and open spaces.

PART 1
GENERAL

General Interpretation

1 In these byelaws:

“the Council” means the Council of the District of Lewes.

“the ground” means any of the grounds listed in Schedule 1.

“designated area” means an area in the ground which is set aside for a specified purpose, that area and its purpose to be indicated by notices placed in a conspicuous position;

“invalid carriage” means a vehicle, whether mechanically propelled or not,

- (a) the unladen weight of which does not exceed 150 kilograms,
- (b) the width of which does not exceed 0.85 metres, and
- (c) which has been constructed or adapted for use for the carriage of a person suffering from a disability, and used solely by such a person.

Application

- 2** These byelaws apply to all of the areas listed in Schedule 1 unless otherwise stated.

Opening Times

- 3**
- (1) No person shall enter or remain in the ground except during opening hours.
 - (2) “Opening hours” means the days and times during which the ground is open to the public indicated by a notice placed in a conspicuous position at the entrance to the ground.
 - (3) Byelaw 3(1) only applies to the grounds listed in Part A of Schedule 1.

PART 2
PROTECTION OF THE GROUND, ITS WILDLIFE AND THE PUBLIC

Protection of structures and plants

- 4 (1) No person shall without reasonable excuse remove from or displace within the ground:
- (a) any barrier, post, seat, or implement, or any part of a structure or ornament provided for use in the laying out or maintenance of the ground; or
 - (b) any stone, soil or turf or the whole or any part of any plant, shrub or tree.
- (2) No person shall walk on or ride, drive or station a horse or any vehicle over:
- (a) any flower bed, shrub or plant;
 - (b) any ground in the course of preparation as a flower bed or for the growth of any tree, shrub or plant; or
 - (c) any part of the ground set aside by the Council for the renovation of turf or for other landscaping purposes and indicated by a notice conspicuously displayed.

Unauthorised erection of structures

- 5 No person shall without the consent of the Council erect any barrier, post, ride or swing, building or any other structure.

Grazing

- 6 No person shall without the consent of the Council turn out or permit any animal for which he is responsible to graze in the ground.

Protection of wildlife

- 7 No person shall kill, injure, take or disturb any animal, or engage in hunting or shooting, or the setting of traps or nets or the laying of snares.

Camping

- 8 No person shall without the consent of the Council erect a tent or use a vehicle, caravan or any other structure for the purpose of camping except in a designated area for camping.

Fires

- 9 (1) No person shall light a fire or place, throw or drop a lighted match or any other thing likely to cause a fire.
- (2) Byelaw 9(1) shall not apply to:
- (a) any event at which the Council has given permission that fires may be lit;
 - (b) the use in a designated area for camping of a properly constructed camping stove or barbecue in such a manner as to safeguard against damage to the ground or danger to any person.

Missiles

- 10 No person shall throw or use any device to propel or discharge in the ground any object which is liable to cause injury to any other person.

Interference with life-saving equipment

- 11 (1) No person shall except in case of emergency remove from or displace within the ground or otherwise tamper with any life-saving appliance provided by the Council.
- (2) Byelaw 11(1) only applies to the grounds listed in Part B of Schedule 1.

PART 3 HORSES, CYCLES AND VEHICLES

Interpretation of Part 3

- 12 In this Part:

“designated route” means a route in or through the grounds which is set aside for a specified purpose, that route and its purpose to be indicated by notices placed in a conspicuous position;

“motor cycle” means a mechanically propelled vehicle, not being an invalid carriage, with less than four wheels and the weight of which does not exceed 410 kilograms;

“motor vehicle” means a mechanically propelled vehicle other than a motor cycle or invalid carriage;

“trailer” means a vehicle drawn by a motor vehicle, and includes a caravan.

Horses

- 13 (1) No person shall ride a horse in the ground except in the exercise of a lawful right or privilege.
- (2) In any part of the ground where horseriding is permitted by virtue of a lawful right or privilege, no person shall ride a horse in such a manner as to cause danger to any other person.

Cycling

- 14 No person shall without reasonable excuse ride a cycle in the ground except in any part of the ground where there is right of way for cycles or on a designated route for cycling.

Motor Vehicles

- 15 No person shall without reasonable excuse bring into or drive in the ground a motor cycle, motor vehicle or trailer except in any part of the ground where there is a right of way for that class of vehicle.

Overnight Parking

- 16 No person shall, without the consent of the Council, leave or cause or permit to be left any motor cycle, motor vehicle or trailer in the ground between the hours of 12 midnight and 6am.

PART 4 PLAY AREAS, GAMES AND SPORTS

Interpretation of Part 4

- 17 In this Part:

“ball games” means any game involving throwing, catching, kicking, batting or running with any ball or other object designed for throwing and catching, but does not include cricket;

“golf course” means any area within the ground set aside for the purposes of playing golf and includes any golf driving range, golf practice area or putting course;

“self-propelled vehicle” means a vehicle other than a cycle, invalid carriage or pram which is propelled by the weight or force of one or more persons skating, sliding or riding on the vehicle or by one or more persons pulling or pushing the vehicle.

Children's Play Areas

- 18 No person aged 14 years or over shall enter or remain in a designated area which is a children's' play area unless bona fide in charge of a child under the age of 14 years.

Children's Play Apparatus

- 19 No person aged 14 years or over shall use any apparatus stated to be for the exclusive use of persons under the age of 14 years by a notice conspicuously displayed on or near the apparatus.

Skateboarding Etc

- 20 No person shall skate, slide or ride on rollers, skateboards or other self-propelled vehicles in such a manner as to cause danger or give reasonable grounds for annoyance to other persons.

Ball Games

- 21 (1) No person shall play ball games in the ground except in connection with an event organised by or held with the consent of the Council.
- (2) Byelaw 21(1) only applies to the grounds listed in Part C of Schedule 1
- 22 No person shall play ball games outside a designated area for playing ball games in such a manner:
- (a) as to exclude persons not playing ball games from use of that part;
 - (b) as to cause danger or give reasonable grounds for annoyance to any other person in the ground; or
 - (c) which is likely to cause damage to any tree, shrub or plant in the ground.
- 23 It is an offence for any person using a designated area for playing ball games to break any of the rules set out in Schedule 2 and conspicuously displayed on a sign in the designated area when asked by any person to desist from breaking those rules.

Cricket

- 24 No person shall throw or strike with a bat a cricket ball except in a designated area for playing cricket.

Archery

- 25 No person shall engage in the sport of archery except in connection with an event organised by or held with the consent of the Council.

Field Sports

- 26 No person shall throw or put any javelin, hammer, discus or shot except in connection with an event organised by or held with the consent of the Council.

Golf

- 27 No person shall drive, chip or pitch a hard golf ball.

PART 5 WATERWAYS

Interpretation of Part 5

- 28 In this Part:

“waterway” means any river, lake, pool, or other body of water and includes any fountain.

Pollution of Waterways

- 29 (1) No person shall foul or pollute any waterway.
(2) Byelaw 29(1) only applies to the grounds listed in Part D of Schedule 1.

Blocking of Watercourses

- 30 (1) No person shall cause or permit the flow of any drain or watercourse in the ground to be obstructed or diverted, or open, shut or otherwise move or operate any sluice or similar apparatus.
(2) Byelaw 30(1) only applies to the grounds listed in Part D of Schedule 1.

PART 6 MODEL AIRCRAFT

Interpretation of Part 6

31 In this Part:

“model aircraft” means an aircraft which weighs not more than 7 kilograms without its fuel;

“power-driven” means driven by:

- (a) the combustion of petrol vapour or other combustible substances;
- (b) by jet propulsion or by means of a rocket, other than by means of a small reaction motor powered by a solid fuel pellet not exceeding 2.54 centimetres in length; or
- (c) by one or more electric motors or by compressed gas.

General Prohibition

- 32** (1) No person shall cause any power-driven model aircraft to
- (a) take off or otherwise be released for flight, or control the flight of such an aircraft in the ground; or
 - (b) land in the ground without reasonable excuse.
- (2) Byelaw 32(1) only applies to the grounds listed in Part E of Schedule 1.

PART 7 OTHER REGULATED ACTIVITIES

Trading

- 33** No person shall without the consent of the Council provide or offer to provide any service for which a charge is made.

Excessive Noise

- 34** (1) No person shall, after being requested to desist by any other person in the grounds:
- (a) by shouting or singing
 - (b) by playing on a musical instrument; or
 - (c) by operating or permitting to be operated any radio, amplifier, tape recorder or similar device,

make or permit to be made any noise which is so loud or so continuous or repeated as to give reasonable cause for annoyance to other persons in the ground.

- (2) Byelaw 34(1) does not apply to any person holding or taking part in any entertainment held with the consent of the Council.

Public Shows and Performances

- 35 No person shall without the consent of the Council hold or take part in any public show or performance.

Aircraft, Hang-gliders and Hot-Air Balloons

- 36 No person shall except in case of emergency or with the consent of the Council take off from or land in the ground in an aircraft, helicopter, hang-glider or hot-air balloon.

Kites

- 37 No person shall fly any kite in such a manner as to cause danger or give reasonable grounds for annoyance to any other person.

Metal Detectors

- 38 No person shall without the consent of the Council use any device designed or adapted for detecting or locating any metal or mineral in the ground.

PART 8 MISCELLANEOUS

Obstruction

- 39 No person shall:
- (a) obstruct any officer of the Council in the proper execution of his duties;
 - (b) obstruct any person carrying out an act which is necessary to the proper execution of any contract with the Council; or
 - (c) obstruct any other person in the proper use of the ground.

Savings

- 40 It shall not be an offence under these byelaws for an officer of the Council or any person acting in accordance with a contract with the Council to do anything necessary to the proper execution of his duty.

- 41 Nothing done in or under these byelaws shall in any respect prejudice or injuriously affect any public right of way through the ground, or the rights of any person acting lawfully by virtue of some estate, right or interest in, over or affecting the ground or any part of the ground.

Removal of Offenders

- 42 Any person offending against any of these byelaws may be removed from the ground by an officer of the Council or a constable.

Penalty

- 43 Any person offending against any of these byelaws shall be liable on summary conviction to a fine not exceeding level 2 on the standard scale.

Revocation

- 44 (a) The byelaws made by the Urban District Council of Seaford on 12 November 1928 and allowed by the Minister of Health on 27 December 1928 relating to the Pleasure Ground known as "The Salts" situate on the Parade, Seaford are hereby revoked.
- (b) The byelaws made by the Borough of Lewes on 13 June 1960 and confirmed by the Secretary of State for the Home Department on 20 August 1960 relating to Bell Lane Recreation Ground are hereby revoked.
- (c) The byelaws made by the Borough of Lewes on 12 November 1965 and confirmed by the Secretary of State for the Home Department on 28 January 1966 relating to the Pleasure Grounds at Landport, Priory Grounds, South Malling and Southover Grange are hereby revoked.
- (d) The byelaws made by the District Council of Lewes on 25 July 1997 and confirmed by the Secretary of State for the Home Department on 17 September 1997 are hereby revoked.

SCHEDULE 1

List of Grounds

Lewes

Bell Lane Recreation Ground shown hatched black on Plan LDC 1 attached to these byelaws

Convent Field Recreation Ground shown hatched black on Plan LDC 2 attached to these byelaws

Jubilee Park Recreation Ground shown hatched black on Plan LDC 3 attached to these byelaws

Landport Recreation Ground shown hatched black on Plan LDC 4 attached to these byelaws

Malling Recreation Ground shown hatched black on Plan LDC 5 attached to these byelaws

Neville Recreation Ground shown hatched black on Plan LDC 6 attached to these byelaws

Southover Grange Gardens shown hatched black on Plan LDC 7 attached to these byelaws

Stanley Turner Recreation Ground shown hatched black on Plan LDC 8 attached to these byelaws

Eridge Green shown hatched black on Plan LDC 9 attached to these byelaws

The Gallops shown hatched black on Plan LDC 10 attached to these byelaws

Newhaven

Avis Road Recreation Ground shown hatched black on Plan LDC 11 attached to these byelaws

Eastside Recreation Ground shown hatched black on Plan LDC 12 attached to these byelaws

Fort Road Recreation Ground shown hatched black on Plan LDC 13 attached to these byelaws

Meeching Down Recreation Ground shown hatched black on Plan LDC 14 attached to these byelaws

Valley Road Open Space shown hatched black on Plan LDC 15 attached to these byelaws

Seaford

Chalvington Field Recreation Ground shown hatched black on Plan LDC 16 attached to these byelaws

College Road Open Space shown hatched black on Plan LDC 17 attached to these byelaws

Crouch Gardens Recreation Ground shown hatched black and cross hatched black on Plan LDC 18 attached to these byelaws

Downs Recreation Ground shown hatched black on Plan LDC 19 attached to these byelaws

Hardwicke House Gardens shown hatched black on Plan LDC 20 attached to these byelaws

Lexden Road Open Space shown hatched black on Plan LDC 21 attached to these byelaws

Martello Fields shown hatched black on Plan LDC 22 attached to these byelaws

Normansal Park Open Space shown hatched black on Plan LDC 23 attached to these byelaws

Salts Recreation Ground shown hatched black on Plan LDC 24 attached to these byelaws

Sandore Road Open Space shown hatched black on Plan LDC 25 attached to these byelaws

Village Green shown hatched black on Plan LDC 26 attached to these byelaws

Walmer Road Recreation Ground shown hatched black on Plan LDC 27 attached to these byelaws

Land adjacent to Alfriston Road shown hatched black on Plan LDC 28 attached to these byelaws

Brickfield Open Space shown hatched black on Plan LDC 29 attached to these byelaws

Blatchington Pond shown hatched black on plan LDC 33 attached to these byelaws.

Telscombe

Telscombe Playing Fields shown hatched black on Plan LDC 30 attached to these byelaws

Peacehaven

Meridian Park shown hatched black on Plan LDC 31 attached to these byelaws

Cinque Foil Play Area shown hatched black and cross hatched black on Plan LDC 32 attached to these byelaws

PART A

The grounds referred to in byelaw 3(1) are as follows:

Lewes

Southover Grange Gardens - All of the area shown hatched black on Plan LDC 7.

PART B

The grounds referred to in byelaw 11(1) are as follows:

Lewes

Southover Grange Gardens - All of the area shown hatched black on Plan LDC 7.

PART C

The grounds referred to in byelaw 21(1) are as follows:

Lewes

Southover Grange Gardens - All of the area shown hatched black on Plan LDC 7.

Seaford

That part of Crouch Gardens Recreation Ground which is cross hatched black on Plan LDC 18.

Lexden Road Open Space - All of the area shown hatched black on Plan LDC 21 attached to these byelaws.

Peacehaven

That part of Cinque Foil Play Area which is cross hatched black on Plan LDC 32.

PART D

The grounds referred to in byelaw 29(1) and 30(1) are as follows:

Lewes

Landport Recreation Ground - All of the area shown hatched black on Plan LDC 4.

Southover Grange Gardens - All of the area shown hatched black on Plan LDC 7.

Seaford

Blatchington Pond – All of the area shown hatched black on Plan LDC 33.

Newhaven

Avis Road Recreation Ground - All of the area shown hatched black on Plan LDC 11.

Eastside Recreation Ground - All of the area shown hatched black on Plan LDC 12.

PART E

The grounds referred to in byelaw 32(1) are as follows:

Lewes

Neville Recreation Ground - All of the area shown hatched black on Plan LDC 6.

Southover Grange Gardens - All of the area shown hatched black on Plan LDC 7.

Eridge Green - All of the area shown hatched black on Plan LDC 9.

The Gallops - All of the area shown hatched black on Plan LDC 10.

Newhaven

Valley Road Open Space - All of the area shown hatched black on Plan LDC 15.

Seaford

College Road Open Space - All of the area shown hatched black on Plan LDC 17.

Hardwicke House Gardens - All of the area shown hatched black on Plan LDC 20.

Lexden Road Open Space - All of the area shown hatched black on Plan LDC 21.

Normansal Park Open Space - All of the area shown hatched black on Plan LDC 23.

Sandore Road Open Space - All of the area shown hatched black on Plan LDC 25.

Land adjacent to Alfriston Road - All of the area shown hatched black on Plan LDC 28.

Brickfield Open Space - All of the area shown hatched black on Plan LDC 29.

SCHEDULE 2

Rules for Playing Ball Games in Designated Areas

Byelaw 23

Any person using a designated area for playing ball games must comply with the following rules:

- (1) No person shall play any game other than those ball games for which the area has been set aside.
- (2) No person shall obstruct any other person who is playing in accordance with these rules.
- (3) Where exclusive use has been granted to a person or group of persons by the Council for a specified period, no other person shall play during that period.
- (4) Subject to paragraph(5), where the area is already in use by any person their permission to play must be sought by any other person wishing to play.
- (5) Except where they have been granted exclusive use by the Council for more than two hours, any person using the area shall vacate it if they have played continuously for two hours or more and know that any other person wishes to use the area.
- (6) No person shall play when a notice has been placed in a conspicuous position by the Council prohibiting play in that area of the ground.

LDC. Plan No 1



Lewes District Council
www.lewes.gov.uk

Estates & Valuation Services

BYELAWS PLEASURE GROUNDS & OPEN SPACES BELL LANE RECREATION GROUND LEWES.

O.S. MAP REF:
TQ 4009 NE

DEED PACKET NO.:
219

SCALE:
1:1250

PLAN NO.:
E 82/03

Reproduced from the Ordnance Survey map with the sanction of the Controller of H.M. Stationery Office. Crown Copyright reserved.

REV:

N



LDC. Plan No 2

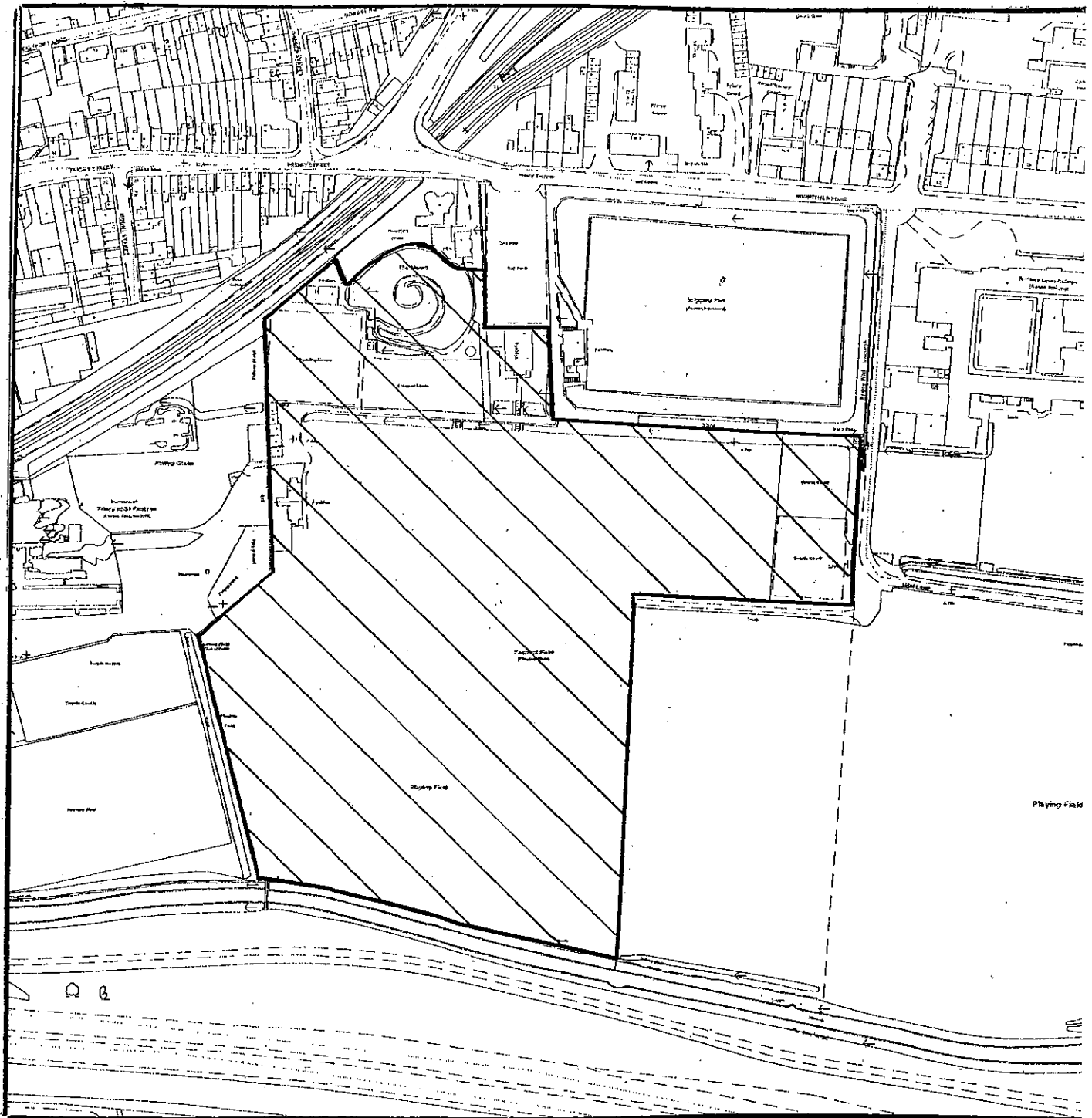

Lewes District Council
www.lewes.gov.uk

Estates & Valuation Services

BYELAWS PLEASURE GROUNDS & OPEN SPACES CONVENT FIELD LEWES.

O.S. MAP REF:
TQ 4109 NE/SE

DEED PACKET NO.:
216/217/ 218

SCALE:
1:2500

PLAN NO
E 83/03

Reproduced from the Ordnance Survey map with the sanction of the Controller of H.M. Stationery Office. Crown Copyright reserved.

REV:

N



LDC. Plan No 3

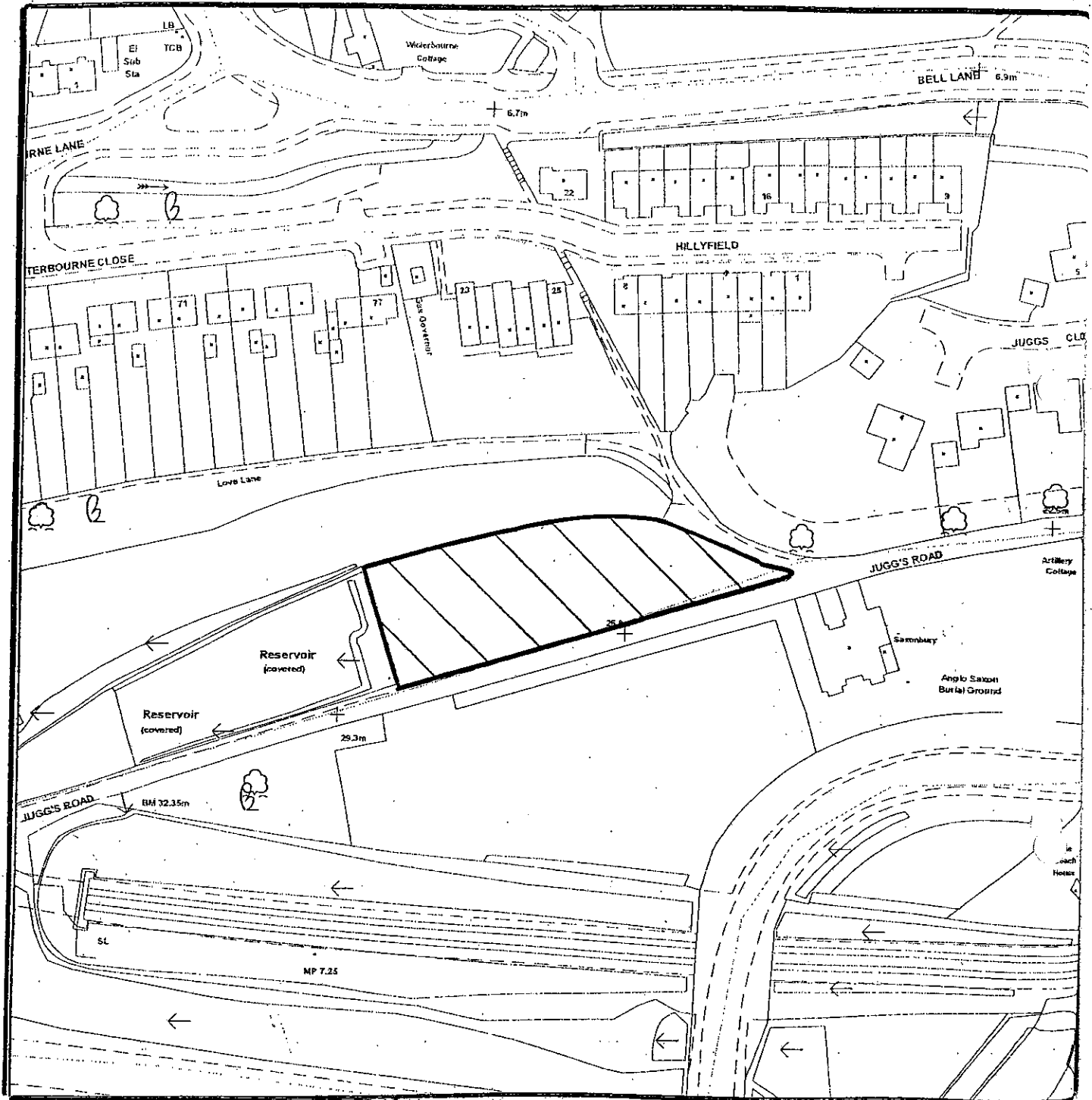

Lewes District Council
www.lewes.gov.uk

Estates & Valuation Services

BYELAWS PLEASURE GROUNDS & OPEN SPACES JUBILEE PARK LEWES.

O.S. MAP REF:
TQ 4009 NE

DEED PACKET NO.:
235

SCALE:
1:1250

PLAN NO.:
E 84/03

Reproduced from the Ordnance Survey map with the sanction of the Controller of H.M. Stationery Office. Crown Copyright reserved.

REV:

N



LDC. Plan No 4

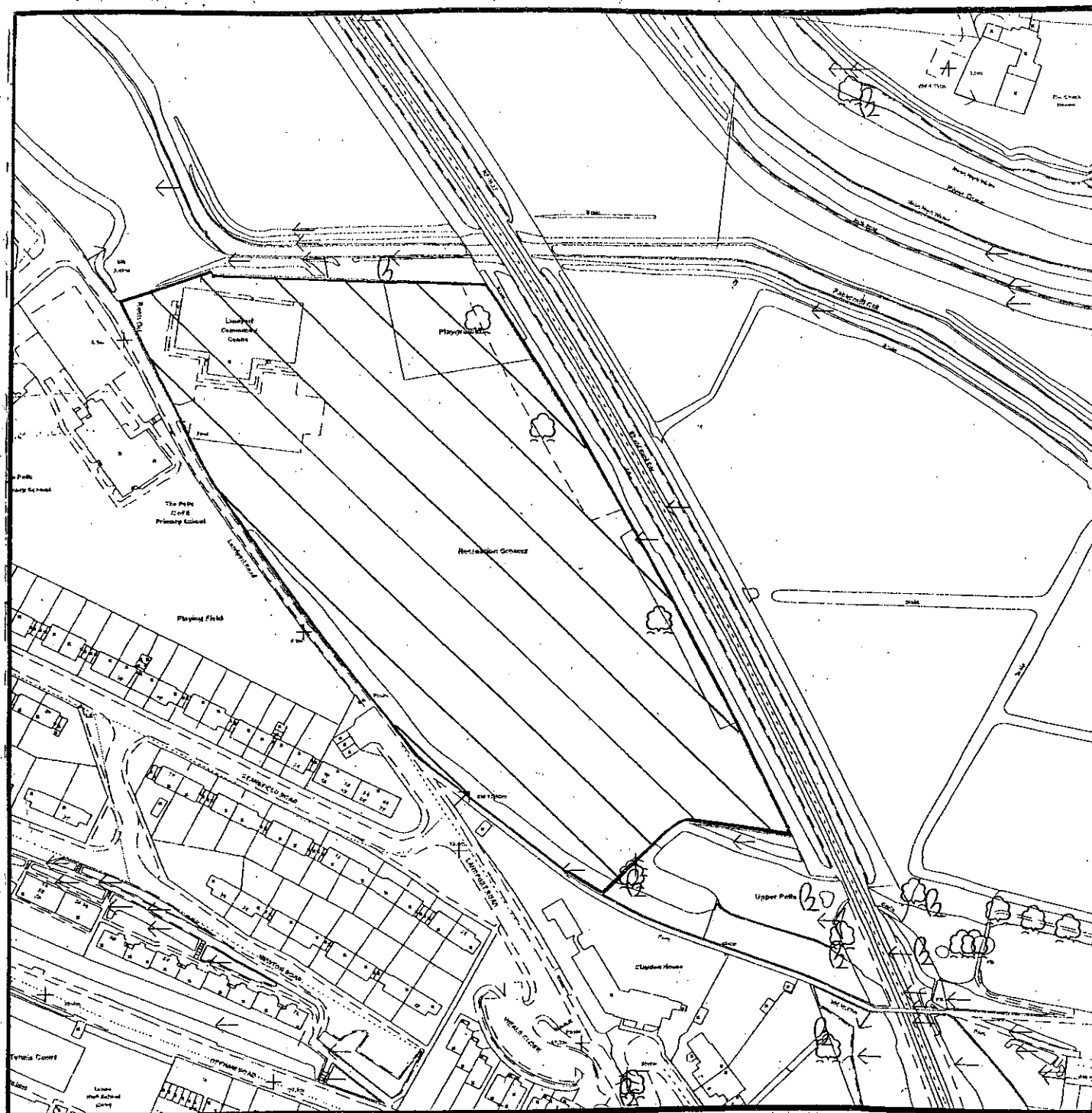

Estates & Valuation Services

BYELAWS PLEASURE GROUNDS & OPEN SPACES LANDPORT RECREATION GROUND LEWES.



O.S. MAP REF:
TQ 4110 NW

DEED PACKET NO.:
231/233/234/239

SCALE:
1:2000

PLAN NO.:
E 85/03

Reproduced from the Ordnance Survey map with the sanction of the Controller of H.M. Stationery Office. Crown Copyright reserved.

REV:

LDC. Plan No 4

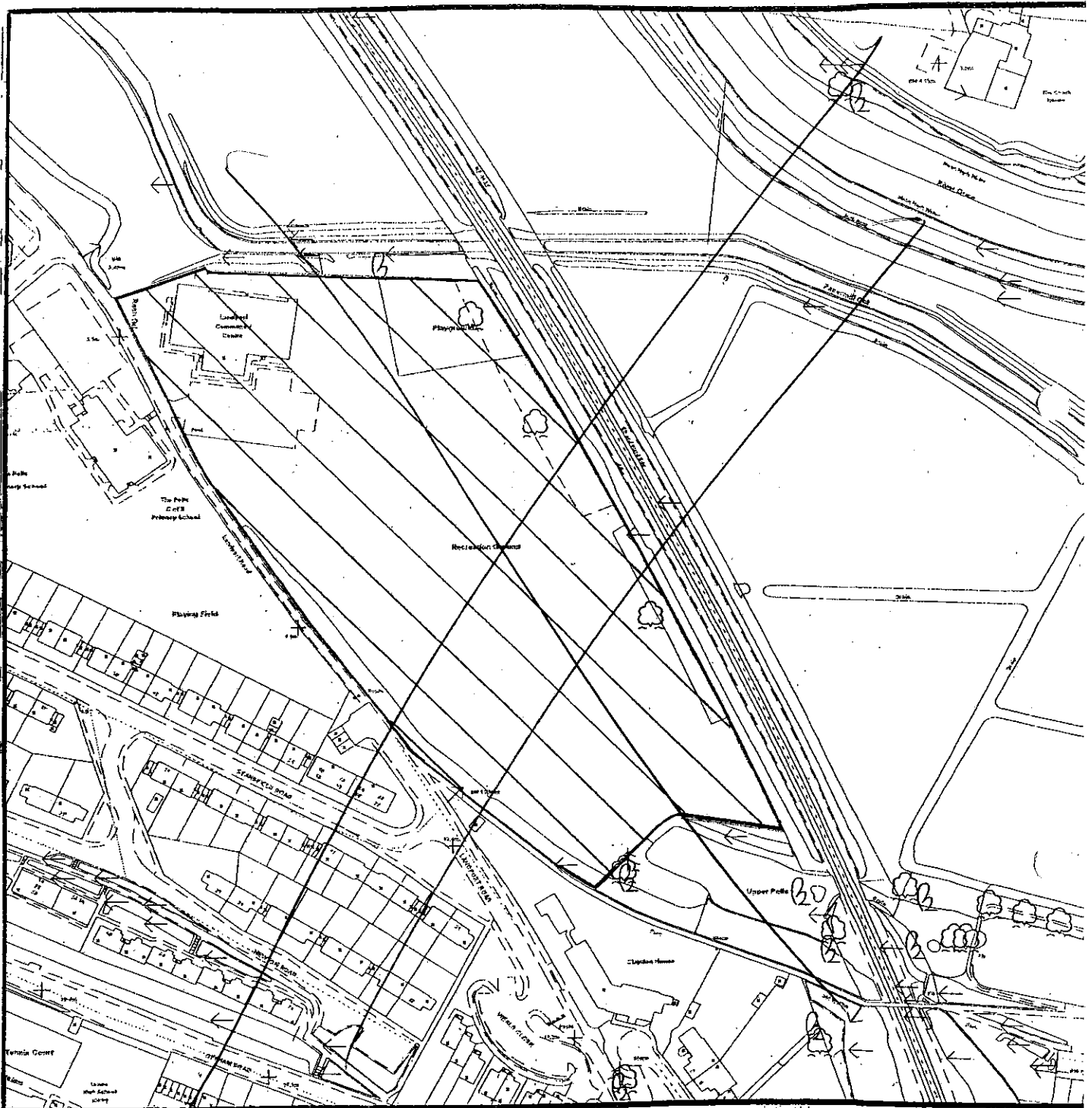

Lewes District Council
www.lewes.gov.uk

Estates & Valuation Services

BYELAWS PLEASURE GROUNDS & OPEN SPACES LANDPORT RECREATION GROUND LEWES.

O.S. MAP REF:
TQ 4110 NW

DEED PACKET NO.:
231/233/234/239

SCALE:
1:2000

PLAN NO.:
E 85/03

Reproduced from the Ordnance Survey map with the sanction of the Controller of H.M. Stationery Office. Crown Copyright reserved.

REV:

N



LDC. Plan No 5

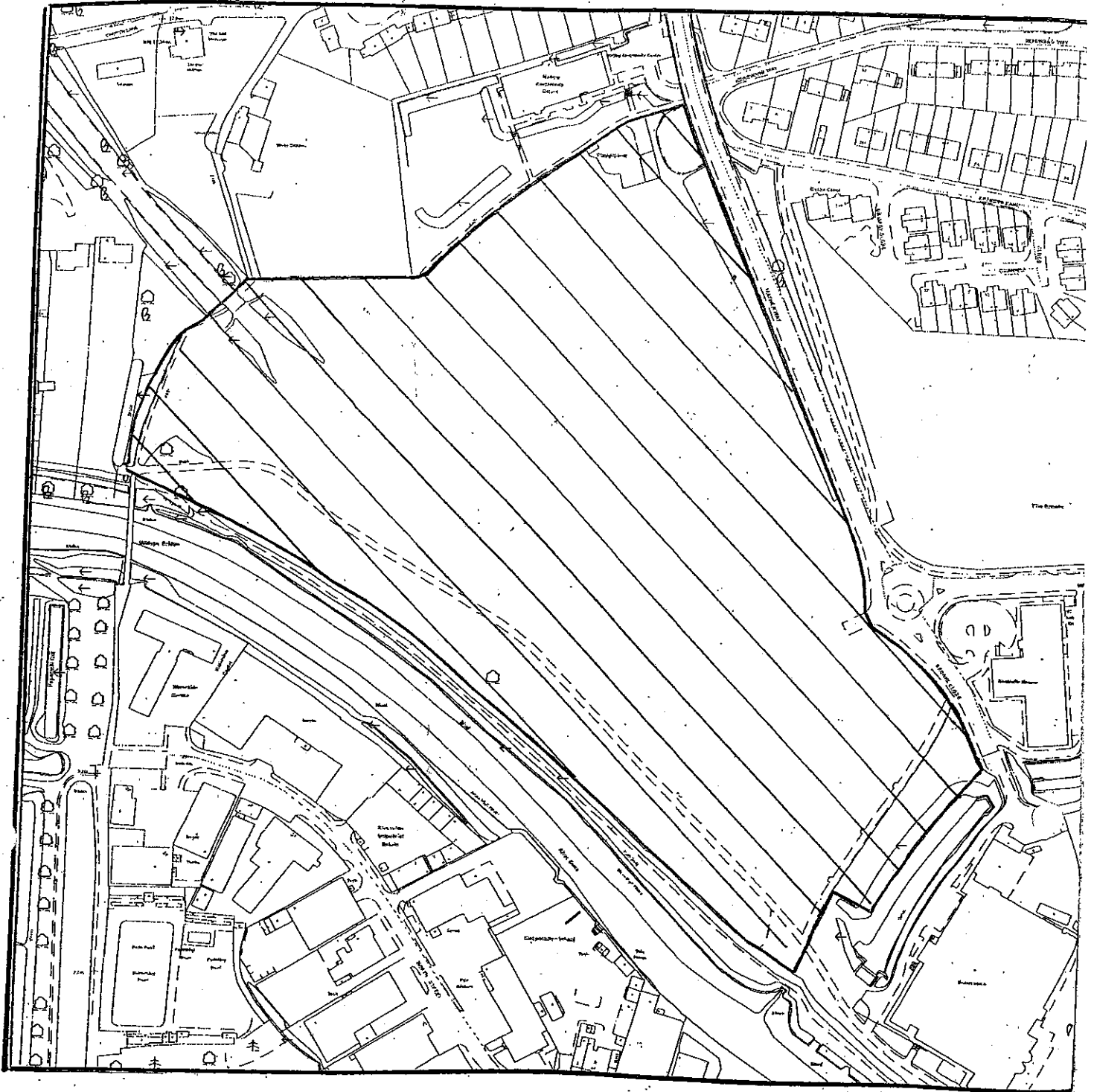

Lewes District Council
www.lewes.gov.uk

Estates & Valuation Services

BYELAWS PLEASURE GROUNDS & OPEN SPACES MALLING RECREATION GROUND LEWES.

O.S. MAP REF:
TQ 4110 NE

DEED PACKET NO.:
75/76/246

SCALE:
1:2500

PLAN NO.:
E 86/03

Reproduced from the Ordnance Survey map with the sanction of the Controller of H.M. Stationery Office. Crown Copyright reserved.

REV:

N



LDC. Plan No 6

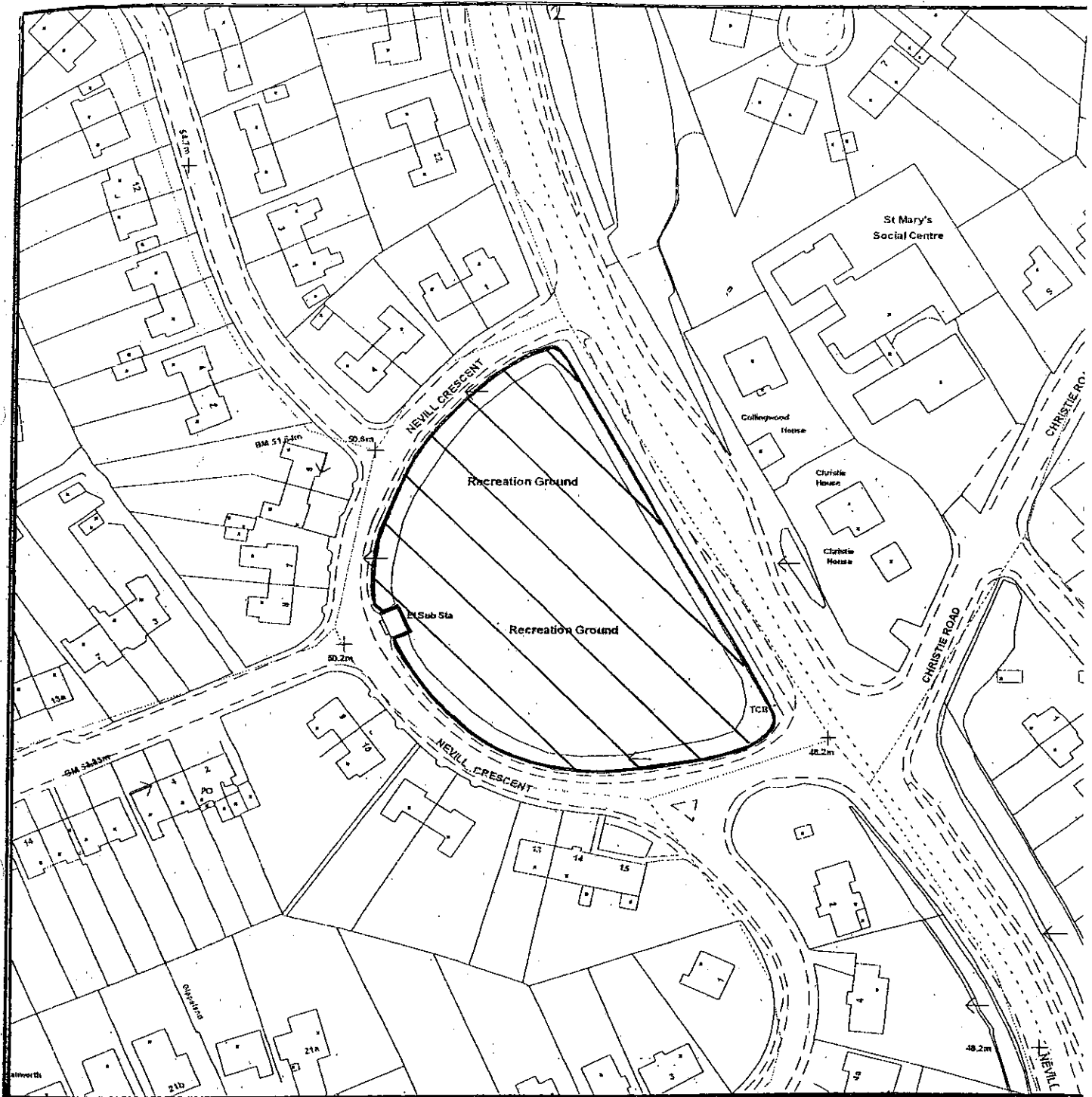

Estates & Valuation Services

BYELAWS PLEASURE GROUNDS & OPEN SPACES NEVILLE RECREATION GROUND LEWES.

N



O.S. MAP REF:
TQ 4010 NW/SW

DEED PACKET NO.:
85

SCALE:
1:1250

PLAN NO.:
E 87/03

Reproduced from the Ordnance Survey map with the sanction of the Controller of H.M. Stationery Office. Crown Copyright reserved.

REV:

LDC. Plan No 7

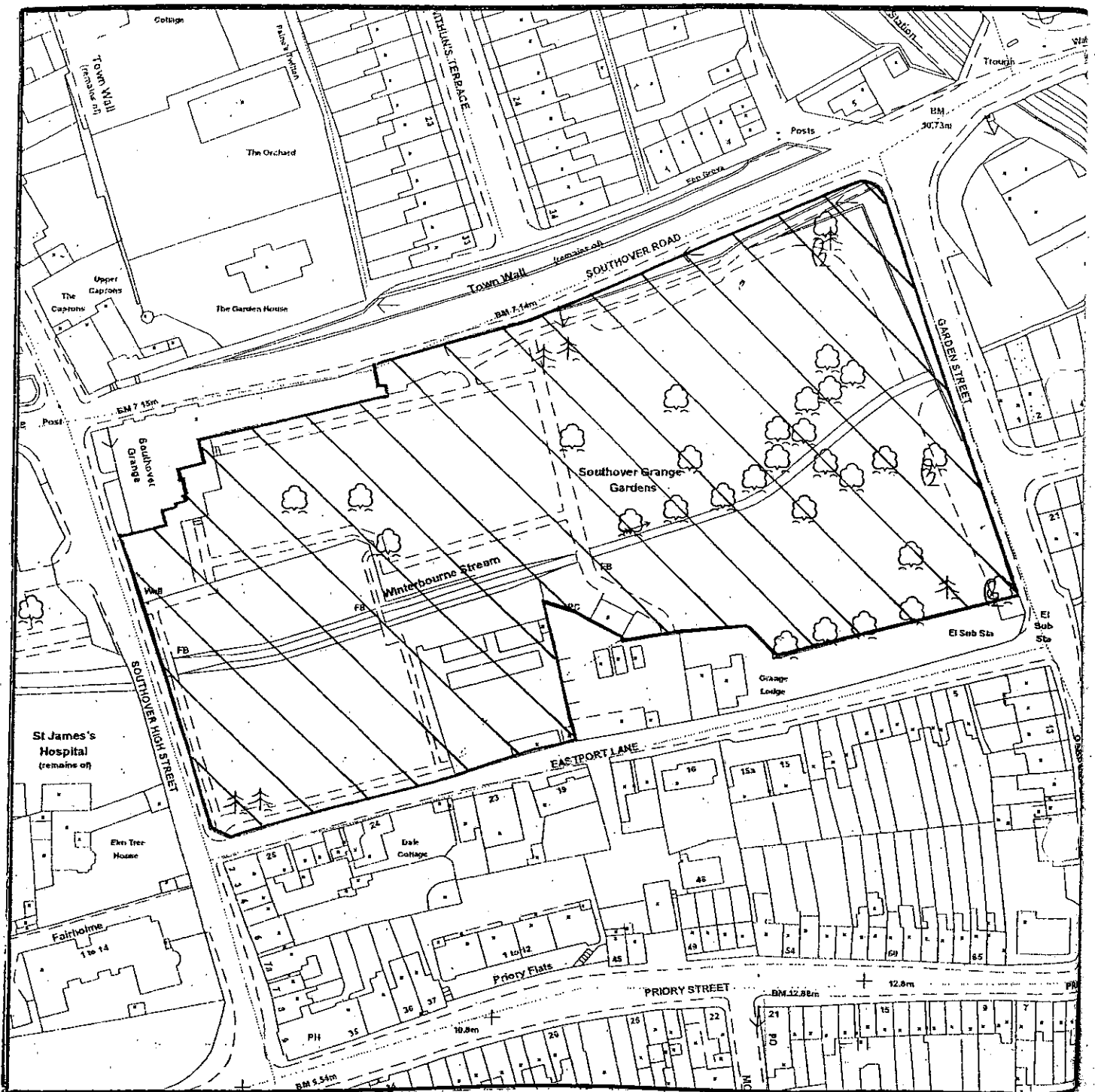

Lewes District Council
www.lewes.gov.uk

Estates & Valuation Services

BYELAWS PLEASURE GROUNDS & OPEN SPACES SOUTHOVER GRANGE GARDENS LEWES.

O.S. MAP REF:
TQ 4109 NW

DEED PACKET NO.:
221

SCALE:
1:1250

PLAN NO.:
E 89/03

Reproduced from the Ordnance Survey map with the sanction of the Controller of H.M. Stationery Office. Crown Copyright reserved.

REV:

N



LDC. Plan No 8



Estates & Valuation Services

BYELAWS PLEASURE GROUNDS & OPEN SPACES STANLEY TURNER PLAYING FIELD LEWES.

O.S. MAP REF:
TQ 4008 NE/4009 SE

DEED PACKET NO.:
220

SCALE:
1:4000

PLAN NO.
E 88/03

Reproduced from the Ordnance Survey map with the sanction of the Controller of
H.M. Stationery Office. Crown Copyright reserved.

REV:



LDC. Plan No 9

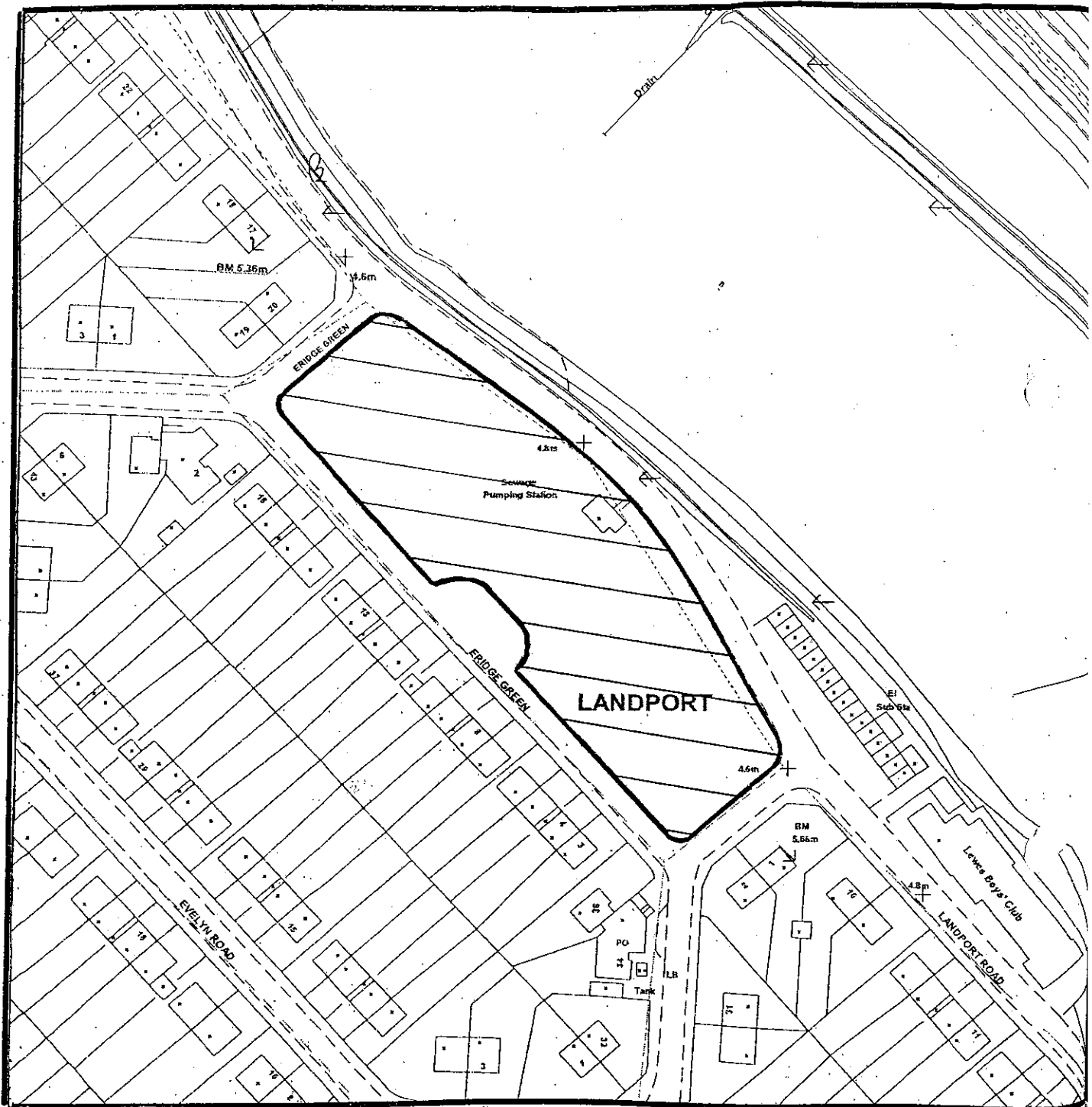

Estates & Valuation Services

BYELAWS PLEASURE GROUNDS & OPEN SPACES ERIDGE GREEN LEWES.

O.S. MAP REF:
TQ 4010NE/4011SE

DEED PACKET NO.:
83

SCALE:
1:1250

PLAN NO:
E 90/03

Reproduced from the Ordnance Survey map with the sanction of the Controller of H.M. Stationery Office. Crown Copyright reserved.



REV:

N

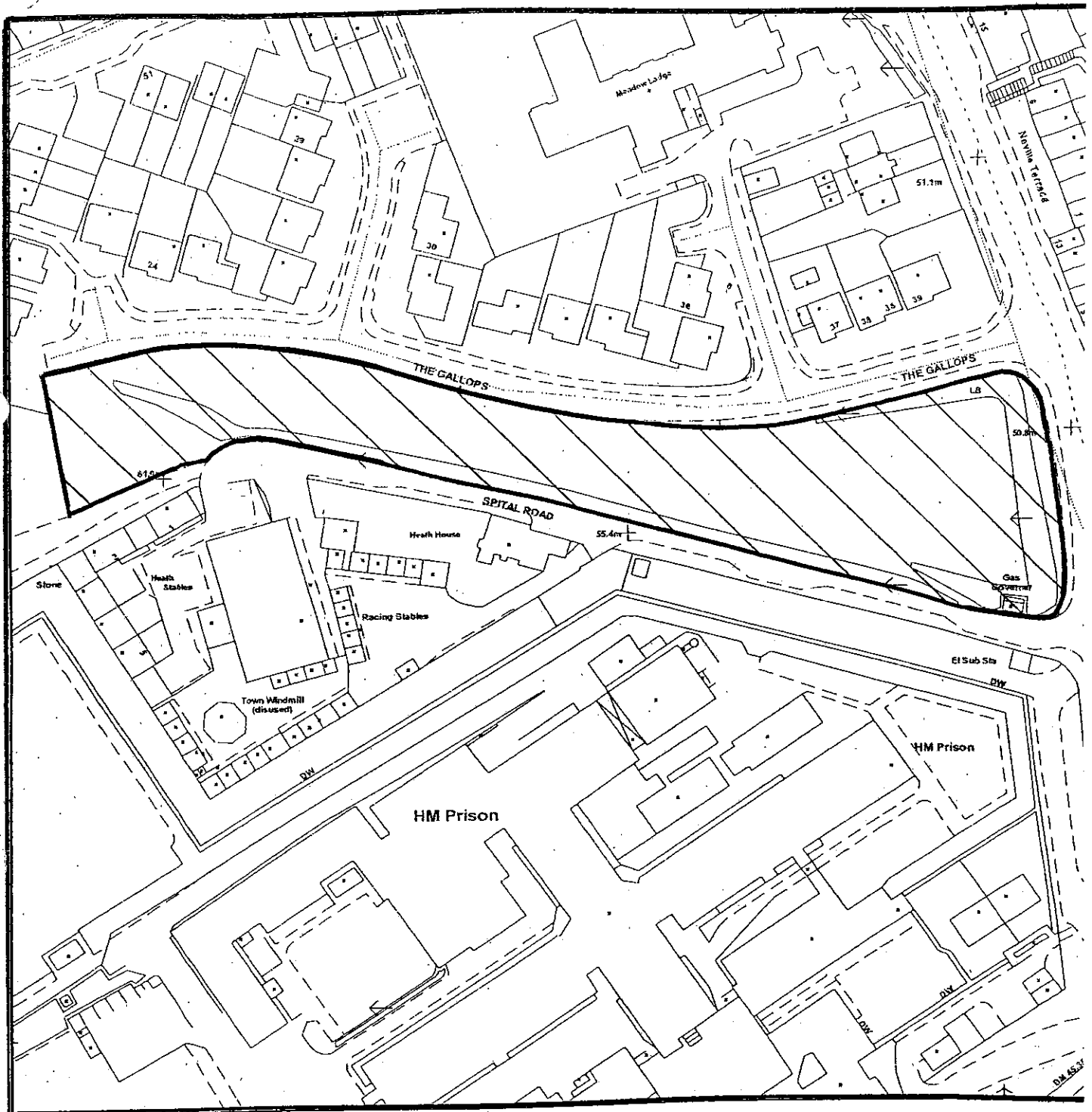

LDC. Plan No 10



 <p>Lewes District Council www.lewes.gov.uk</p> <p>Estates & Valuation Services</p>	<p>BYELAWS PLEASURE GROUNDS & OPEN SPACES THE GALLOPS LEWES.</p>			<p>N</p> 
	<p>O.S. MAP REF: TQ 4010SW/SE</p>	<p>DEED PACKET NO.: 229</p>	<p>SCALE: 1:1250</p>	
	<p>Reproduced from the Ordnance Survey map with the sanction of the Controller of H.M. Stationery Office. Crown Copyright reserved.</p>			<p>PLAN NO.: E 91/03</p> <p>REV:</p>

LDC. Plan No 11

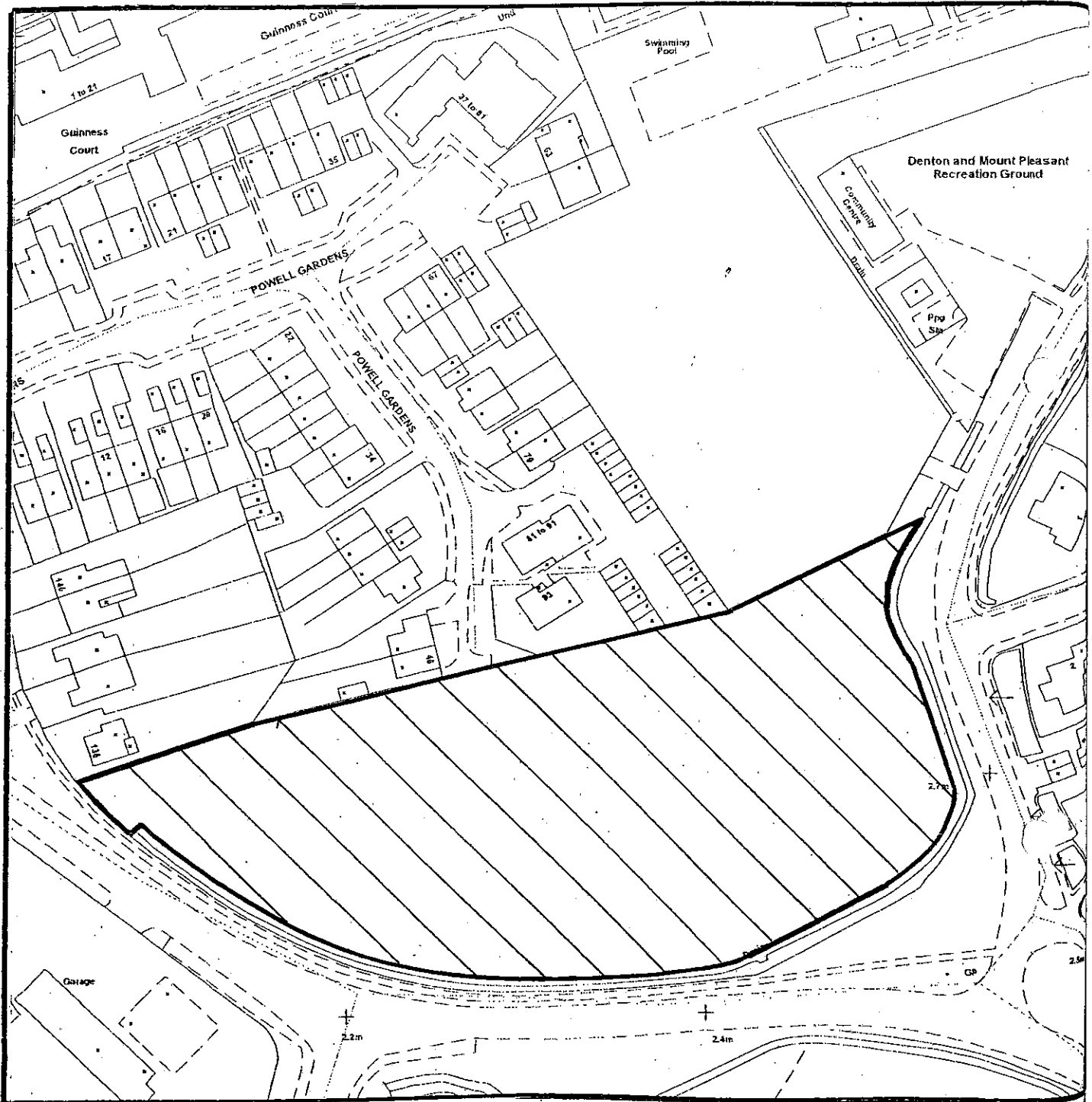

Estates & Valuation Services

BYELAWS PLEASURE GROUNDS & OPEN SPACES AVIS ROAD RECREATION GROUND NEWHAVEN

O.S. MAP REF:
TQ 4502SW

DEED PACKET NO.:
843

SCALE:
1:1250



PLAN NO.:
E 92/03

Reproduced from the Ordnance Survey map with the sanction of the Controller of H.M. Stationery Office. Crown Copyright reserved.

REV:

LDC. Plan No 12

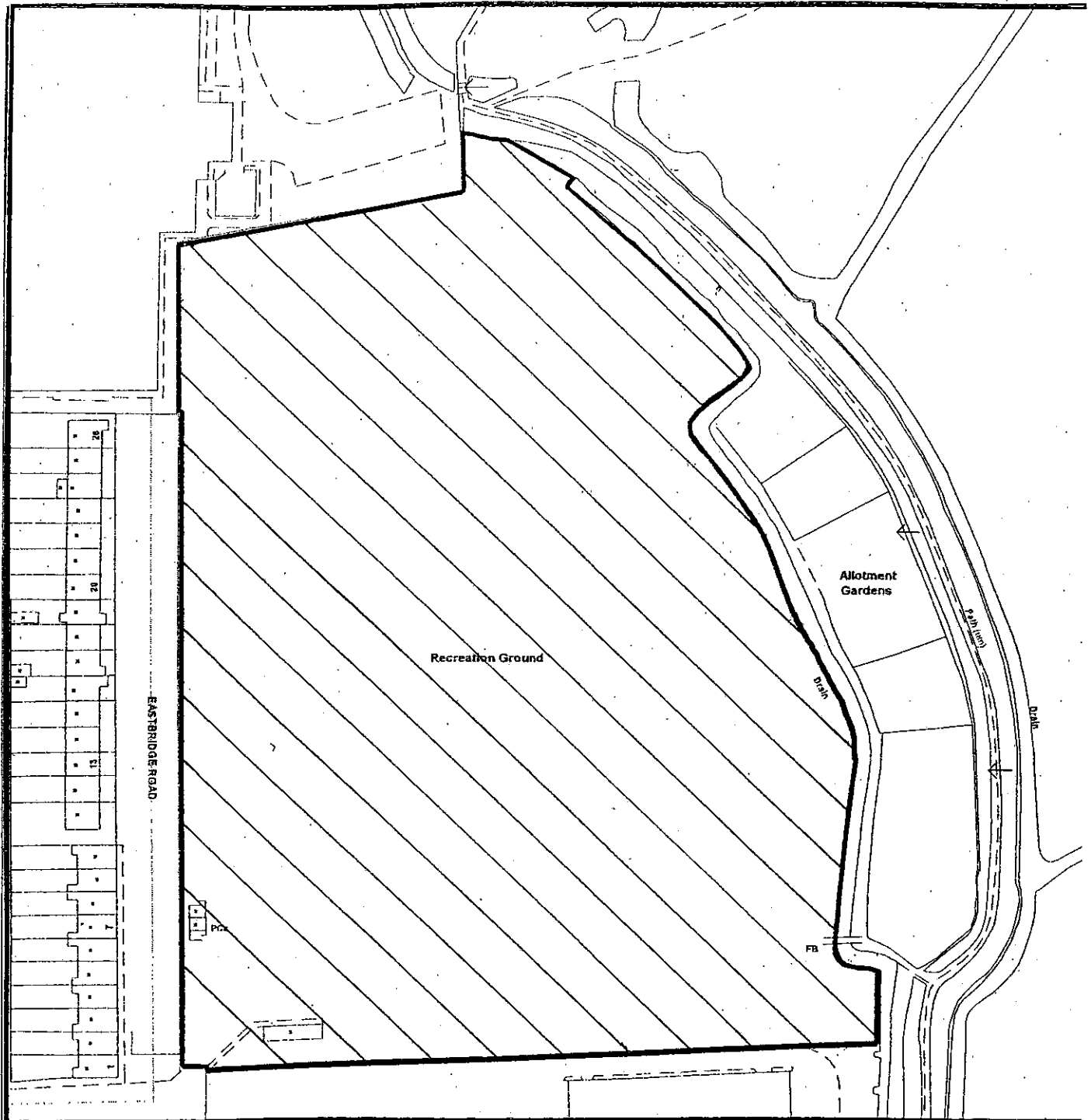

Lewes District Council
www.lewes.gov.uk

Estates & Valuation Services

BYELAWS PLEASURE GROUNDS & OPEN SPACES EASTSIDE RECREATION GROUND NEWHAVEN

O.S. MAP REF:
TQ 4501SW

DEED PACKET NO.:
93

SCALE:
1:1250

PLAN NO
E 93/03

Reproduced from the Ordnance Survey map with the sanction of the Controller of
H.M. Stationery Office. Crown Copyright reserved.

REV:

N



LDC. Plan No 13

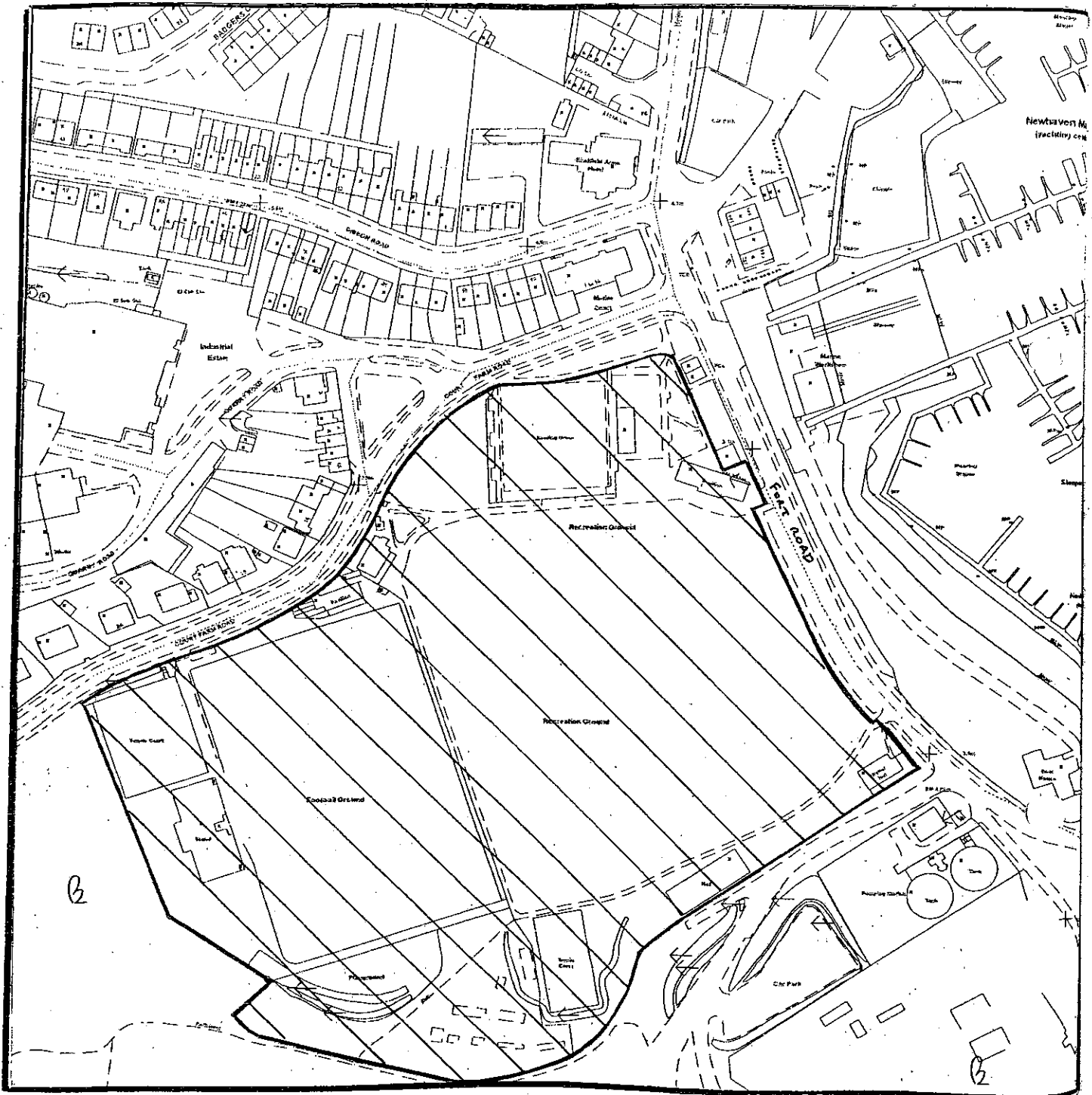

Estates & Valuation Services

BYELAWS PLEASURE GROUNDS & OPEN SPACES FORT ROAD RECREATION GROUND NEWHAVEN

O.S. MAP REF:
TQ 4400NE/SE

DEED PACKET NO.:
426

SCALE:
1:2000



PLAN NO.:
E 94/03

Reproduced from the Ordnance Survey map with the sanction of the Controller of H.M. Stationery Office. Crown Copyright reserved.

REV:

L.D.C Plan No 14



Lewes District Council
www.lewes.gov.uk

Estates & Valuation Services

BYELAWS PLEASURE GROUNDS & OPEN SPACES MEECHING DOWN NEWHAVEN

O.S. MAP REF:
TQ4300NE/4301SE

DEED PACKET NO.:
941

SCALE:
1:2500

PLAN NO.:
E 95/03

Reproduced from the Ordnance Survey map with the sanction of the Controller of H.M. Stationery Office. Crown Copyright reserved.

REV:

LDC. Plan No 15



Lewes District Council
www.lewes.gov.uk

Estates & Valuation Services

BYELAWS PLEASURE GROUNDS & OPEN SPACES VALLEY ROAD OPEN SPACE NEWHAVEN

O.S. MAP REF:
TQ 4301SE

DEED PACKET NO.:
960/965

SCALE:
1:1250

PLAN NO.
E 96/03

Reproduced from the Ordnance Survey map with the sanction of the Controller of H.M. Stationery Office. Crown Copyright reserved.



REV:

N

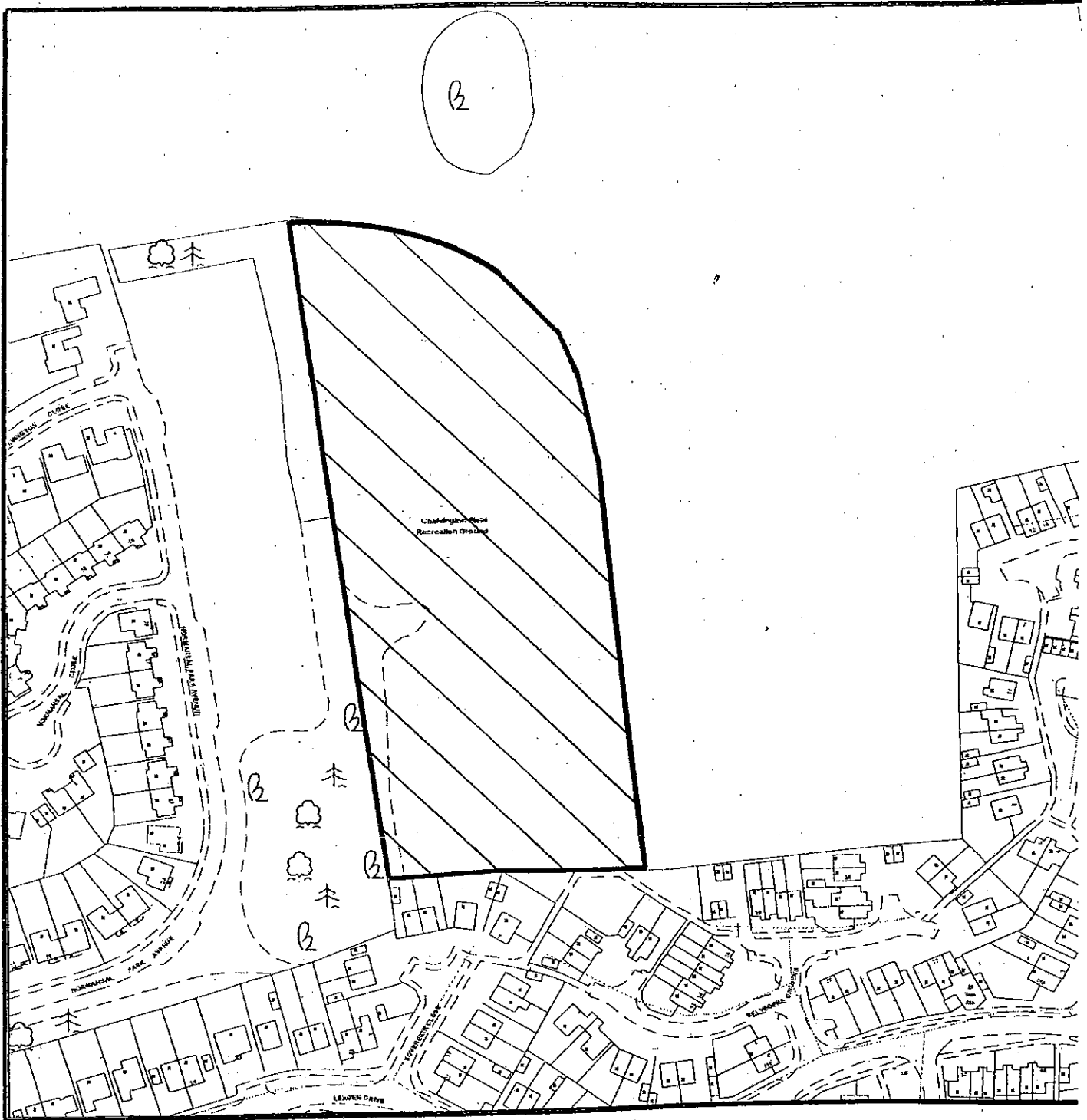

LDC. Plan No 16



 <p>Lewes District Council www.lewes.gov.uk</p> <p>Estates & Valuation Services</p>	<p align="center">BYELAWS PLEASURE GROUNDS & OPEN SPACES CHALVINGTON FIELD SEAFORD</p>			<p align="center">N</p> 
	<p>O.S. MAP REF: TQ 4900 NW</p>	<p>DEED PACKET NO.: 950</p>	<p>SCALE: 1:2000</p>	
	<p>Reproduced from the Ordnance Survey map with the sanction of the Controller of H.M. Stationery Office. Crown Copyright reserved.</p>			<p>PLAN NO E 97/03</p> <p>REV:</p>

LDC. Plan No 17



Estates & Valuation Services

BYELAWS PLEASURE GROUNDS & OPEN SPACES COLLEGE ROAD OPEN SPACES SEAFORD

O.S. MAP REF:
TQ 4898NW/NE

DEED PACKET NO.:
948

SCALE:
1:1250



PLAN NO.:
E 98/03

Reproduced from the Ordnance Survey map with the sanction of the Controller of H.M. Stationery Office. Crown Copyright reserved.

REV:

LDC. Plan No 18

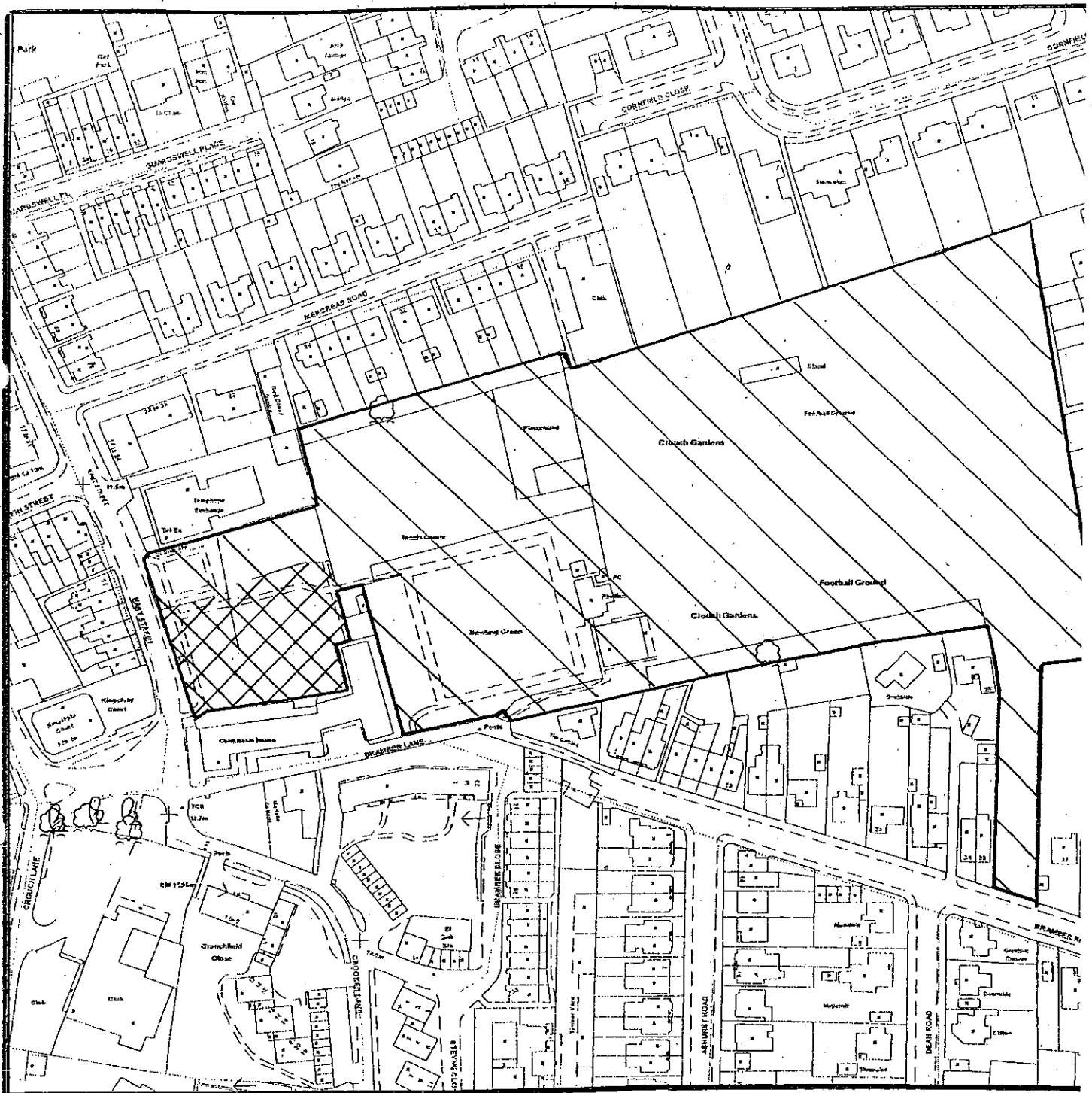

Estates & Valuation Services

BYELAWS PLEASURE GROUNDS & OPEN SPACES CROUCH RECREATION GROUND SEAFORD

O.S. MAP REF:
TQ 4898NE. 4899SE

DEED PACKET NO.:
303

SCALE:
N.T.S

PLAN NO.:
E 99/03

Reproduced from the Ordnance Survey map with the sanction of the Controller of
H.M. Stationery Office. Crown Copyright reserved.

REV:

N



LDC. Plan No 19

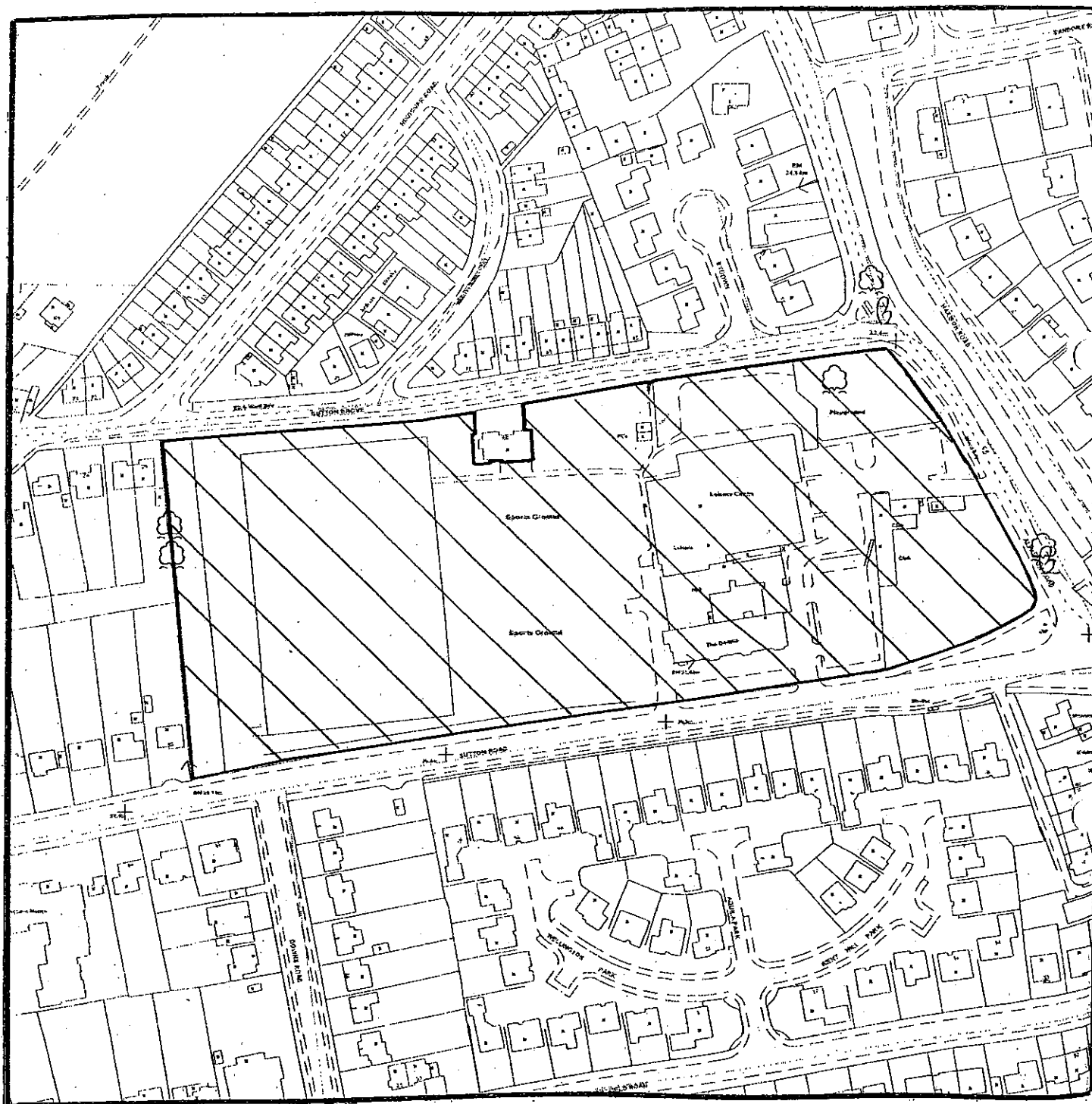

Lewes District Council
www.lewes.gov.uk

Estates & Valuation Services

**BYELAWS
PLEASURE GROUNDS & OPEN SPACES
DOWNS RECREATION GROUND
SEAFORD**

O.S. MAP REF:
TV 4999NW/SW

DEED PACKET NO.:
305

SCALE:
1:2000

PLAN NO.:
E 100/03

Reproduced from the Ordnance Survey map with the sanction of the Controller of H.M. Stationery Office. Crown Copyright reserved.

REV:



LDC. Plan No 20

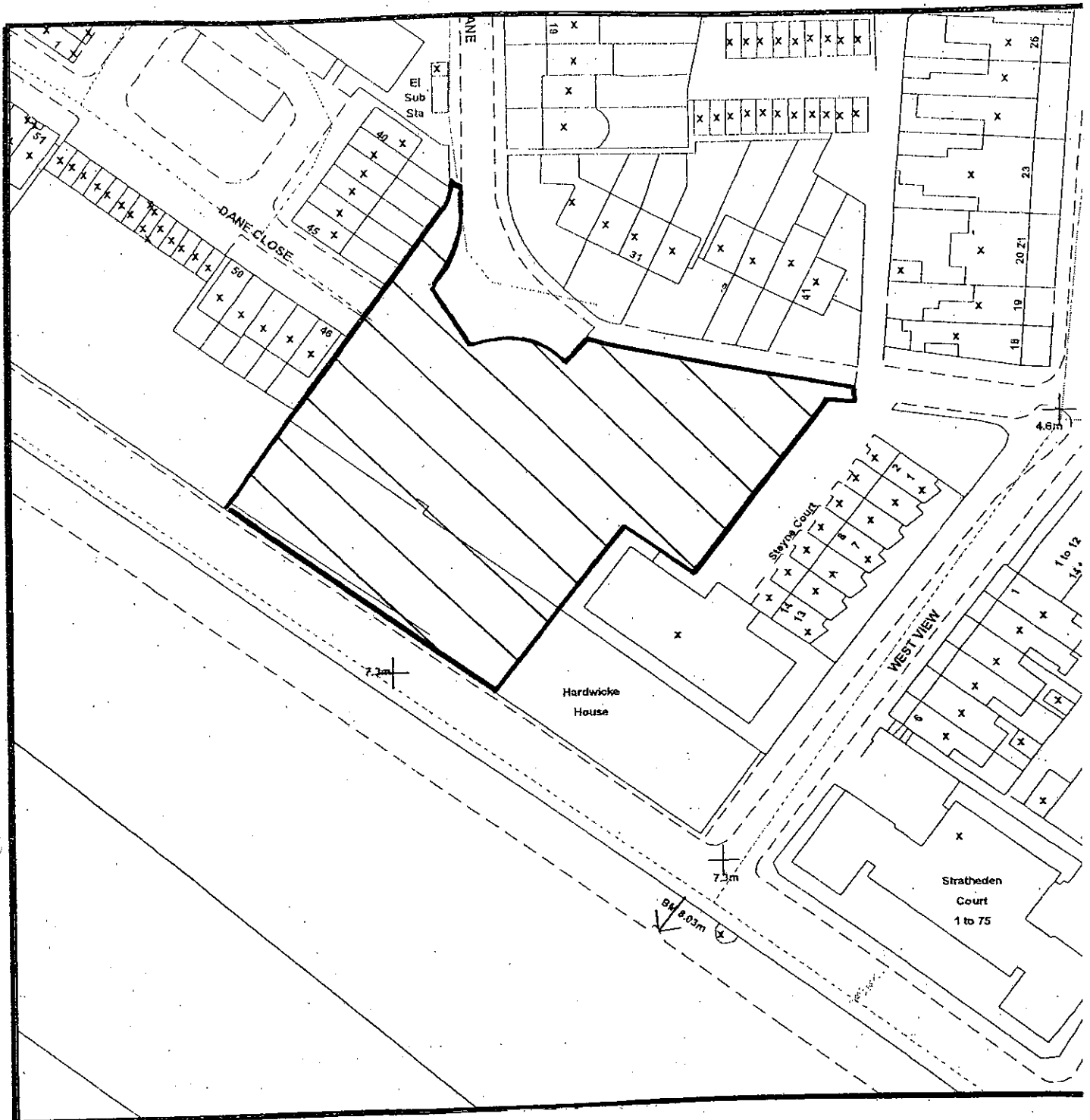

Lewes District Council
www.lewes.gov.uk

Estates & Valuation Services

BYELAWS PLEASURE GROUNDS & OPEN SPACES HARDWICK HOUSE, GARDENS SEAFORD

O.S. MAP REF:
TQ 4898 NW

DEED PACKET NO.:
296

SCALE:
1:1000



PLAN NO
E 101/03

Reproduced from the Ordnance Survey map with the sanction of the Controller of H.M. Stationery Office. Crown Copyright reserved.

REV:

LDC. Plan No 21



Lewes District Council
www.lewes.gov.uk

Estates & Valuation Services

BYELAWS PLEASURE GROUNDS & OPEN SPACES LEXDEN ROAD OPEN SPACE SEAFORD

O.S. MAP REF:
TQ 4800 SE

DEED PACKET NO.:
952

SCALE:
1:1000

PLAN NO.:
E 102/03

Reproduced from the Ordnance Survey map with the sanction of the Controller of
H.M. Stationery Office. Crown Copyright reserved.

REV:

N



LDC. Plan No 22

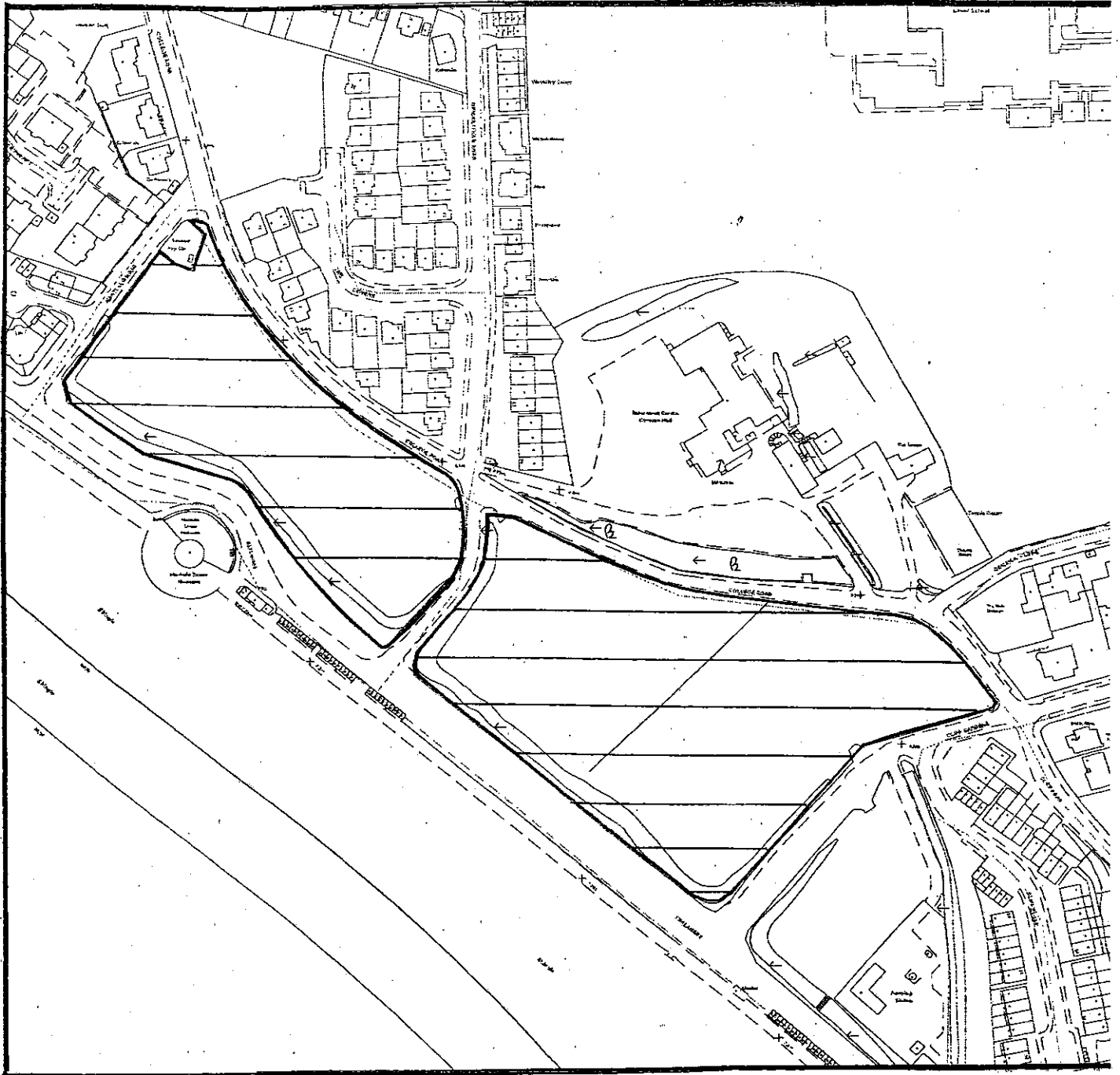

Estates & Valuation Services

BYELAWS PLEASURE GROUNDS & OPEN SPACES MARTELLO FIELDS SEAFORD

O.S. MAP REF:
TQ 4898 SE

DEED PACKET NO.:
VARIOUS

SCALE:
1:2500





PLAN NO
E 103/03

Reproduced from the Ordnance Survey map with the sanction of the Controller of
H.M. Stationery Office. Crown Copyright reserved.

REV:

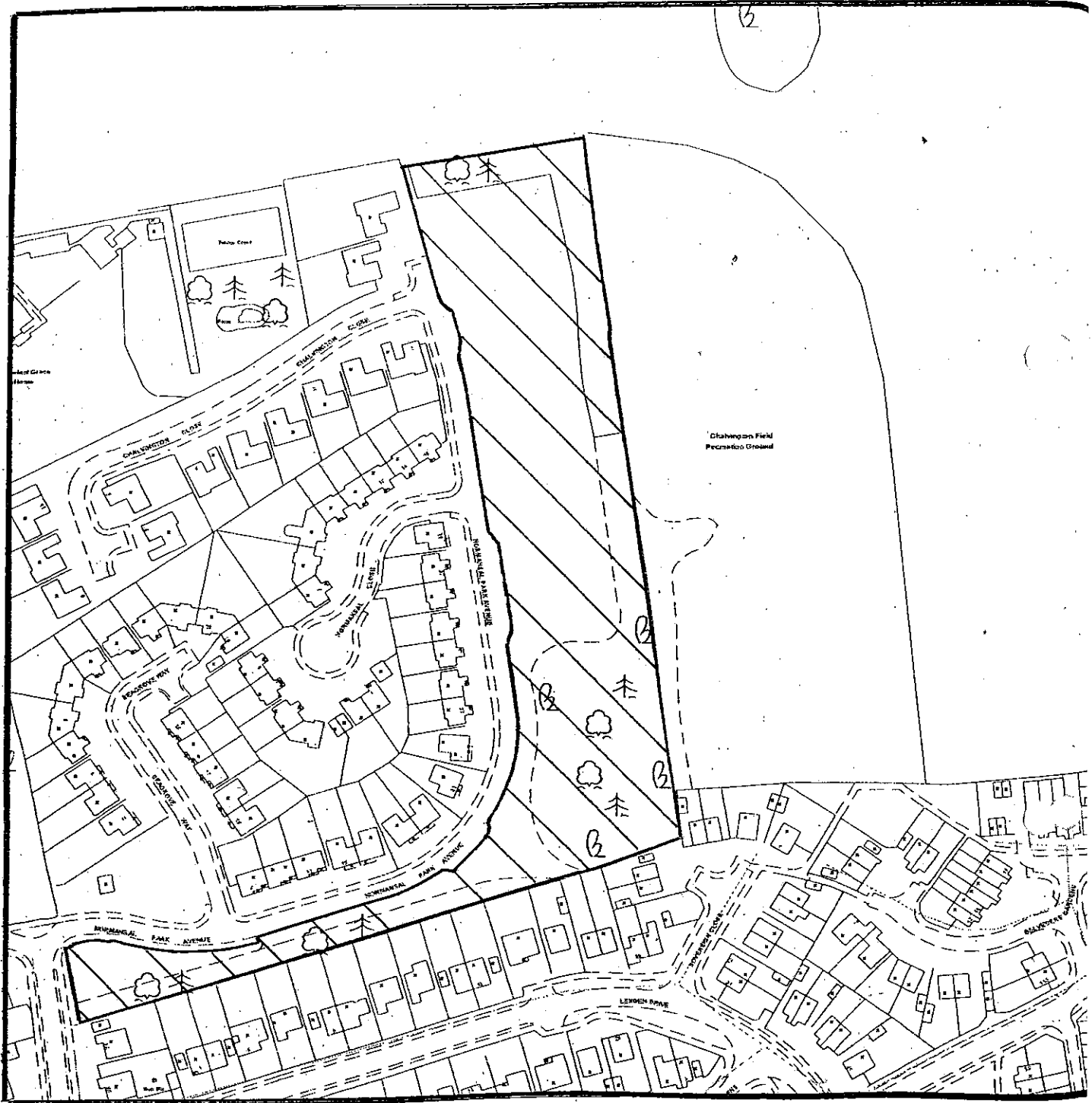
LDC. Plan No 23



 <p>Lewes District Council www.lewes.gov.uk</p>	<p align="center">BYELAWS PLEASURE GROUNDS & OPEN SPACES NORMANSAL PARK OPEN SPACE SEAFORD</p>			<p align="center">N</p> 
<p>Estates & Valuation Services</p>	<p>O.S. MAP REF: TQ 4900NW/SW</p>	<p>DEED PACKET NO.: -</p>	<p>SCALE: 1:2000</p>	<p>PLAN NO.: E 104/03</p>
	<p>Reproduced from the Ordnance Survey map with the sanction of the Controller of H.M. Stationery Office. Crown Copyright reserved.</p>			<p>REV:</p>

LDC. Plan No 24

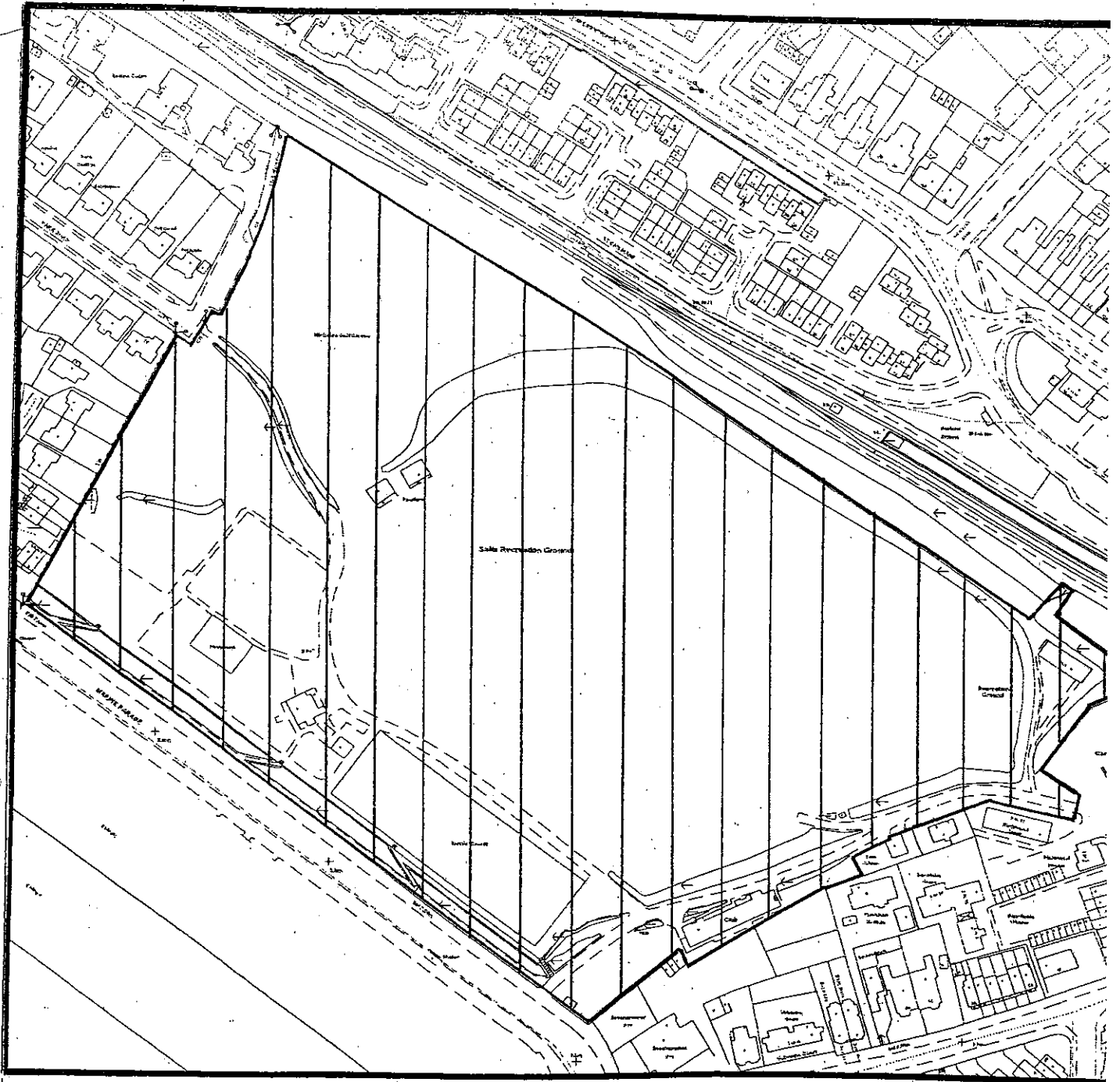

Estates & Valuation Services

BYELAWS PLEASURE GROUNDS & OPEN SPACES SALTS RECREATION GROUND SEAFORD

O.S. MAP REF:
TV 4799SE

DEED PACKET NO.:
277

SCALE:
1:2500

N



PLAN NO.:
E 105/03

Reproduced from the Ordnance Survey map with the sanction of the Controller of
H.M. Stationery Office. Crown Copyright reserved.

REV:

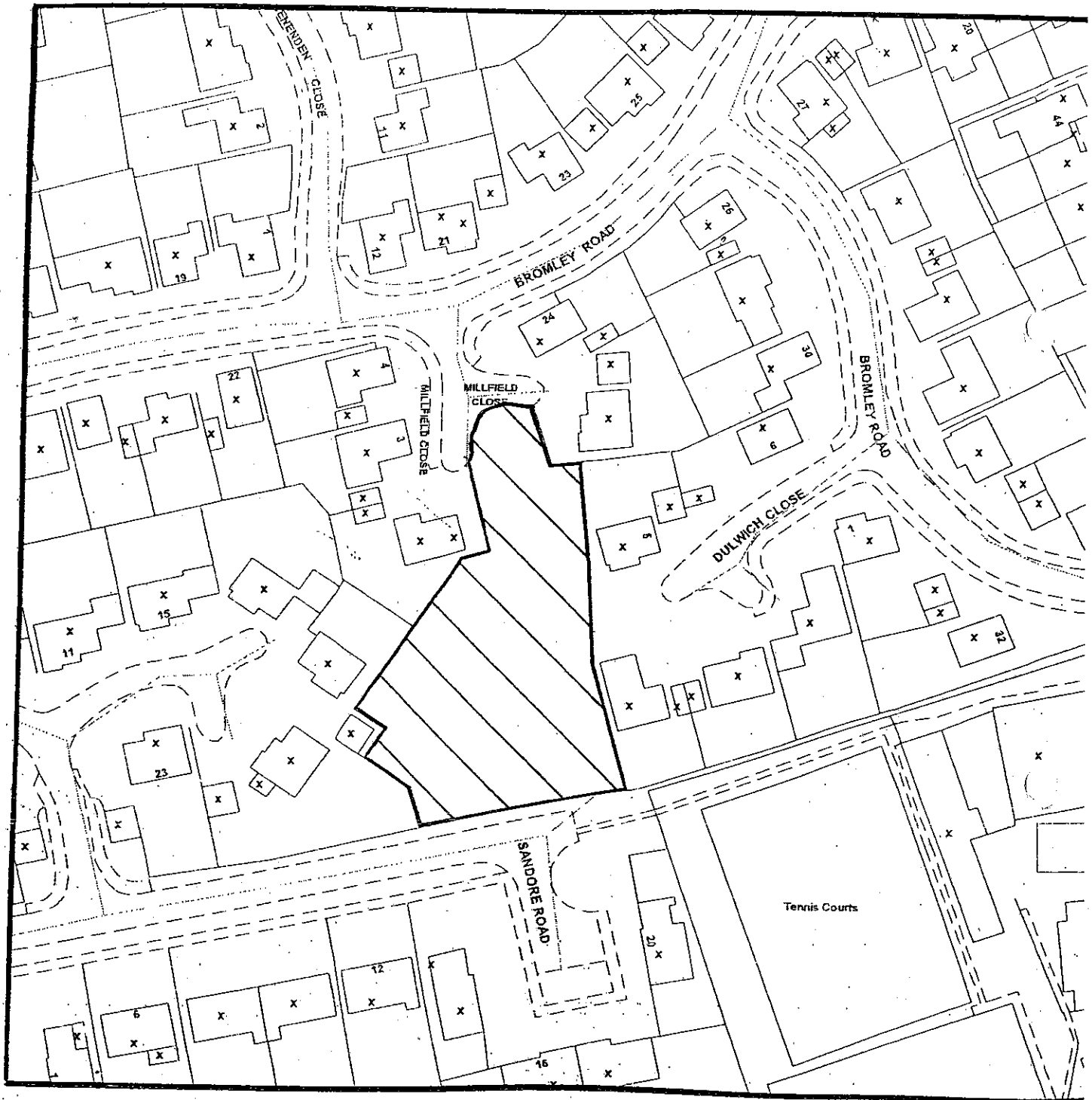
LDC. Plan No 25



 Lewes District Council www.lewes.gov.uk Estates & Valuation Services	BYELAWS PLEASURE GROUNDS & OPEN SPACES SANDORE ROAD, OPEN SPACE SEAFORD			N 	
	O.S. MAP REF:	DEED PACKET NO.:	SCALE:		PLAN NO.:
	TV 4999NW/NE	-	1:1000		E 106/03
	Reproduced from the Ordnance Survey map with the sanction of the Controller of H.M. Stationery Office. Crown Copyright reserved.				REV:

LDC. Plan No 26

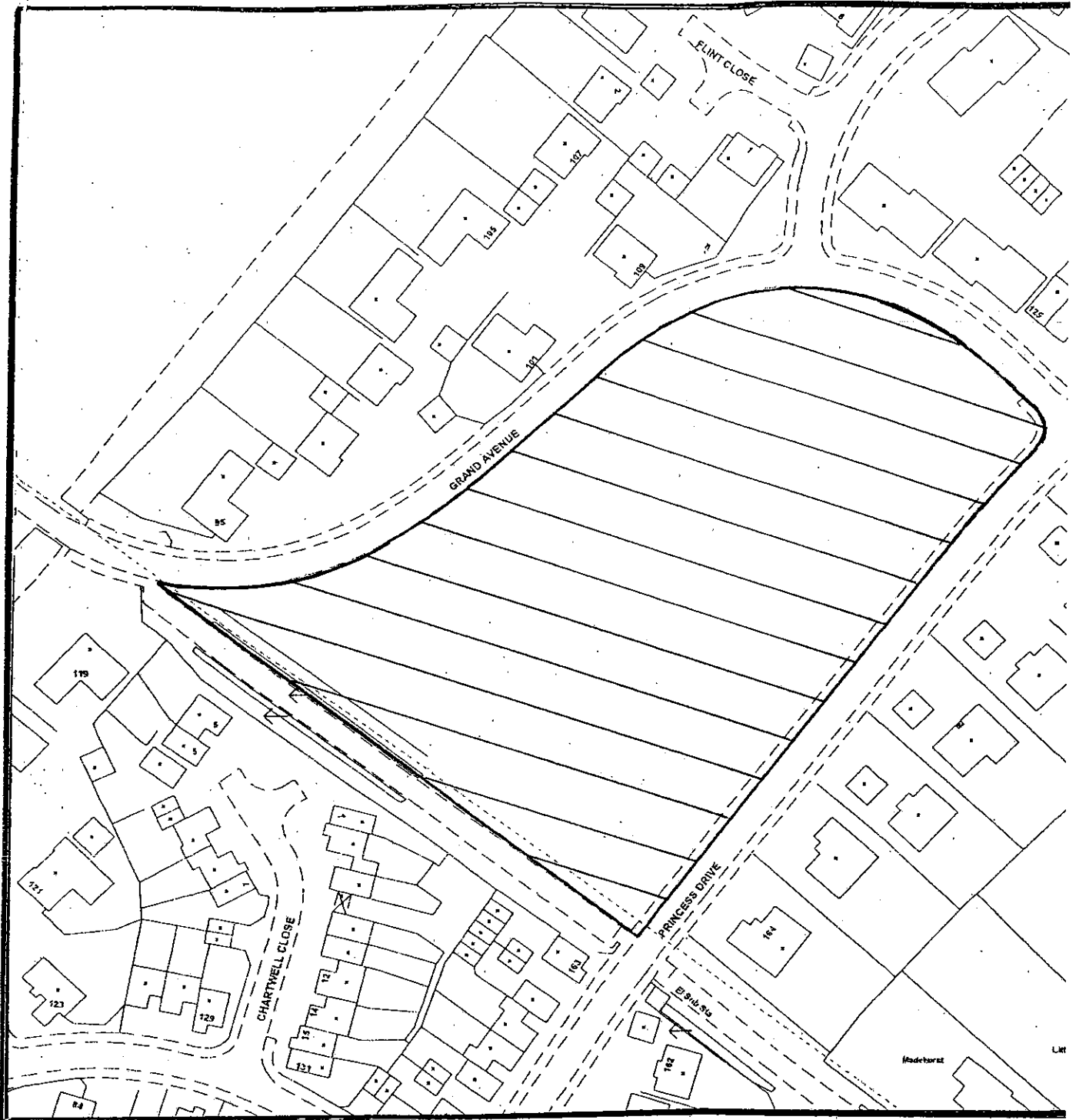

Estates & Valuation Services

BYELAWS PLEASURE GROUNDS & OPEN SPACES VILLAGE GREEN SEAFORD

O.S. MAP REF:
TQ 4800 NW

DEED PACKET NO.:

SCALE:
1:1250



PLAN NO
E 107/03

Reproduced from the Ordnance Survey map with the sanction of the Controller of H.M. Stationery Office. Crown Copyright reserved.

REV:

LDC. Plan No 27



Lewes District Council
www.lewes.gov.uk

Estates & Valuation Services

BYELAWS PLEASURE GROUNDS & OPEN SPACES WALMER ROAD RECREATION GROUND SEAFORD

O.S. MAP REF:
TV 5099NW

DEED PACKET NO.:
321

SCALE:
1:2000

PLAN NO.:
E 108/03

Reproduced from the Ordnance Survey map with the sanction of the Controller of H.M. Stationery Office. Crown Copyright reserved.

REV:

N



LDC. Plan No 28

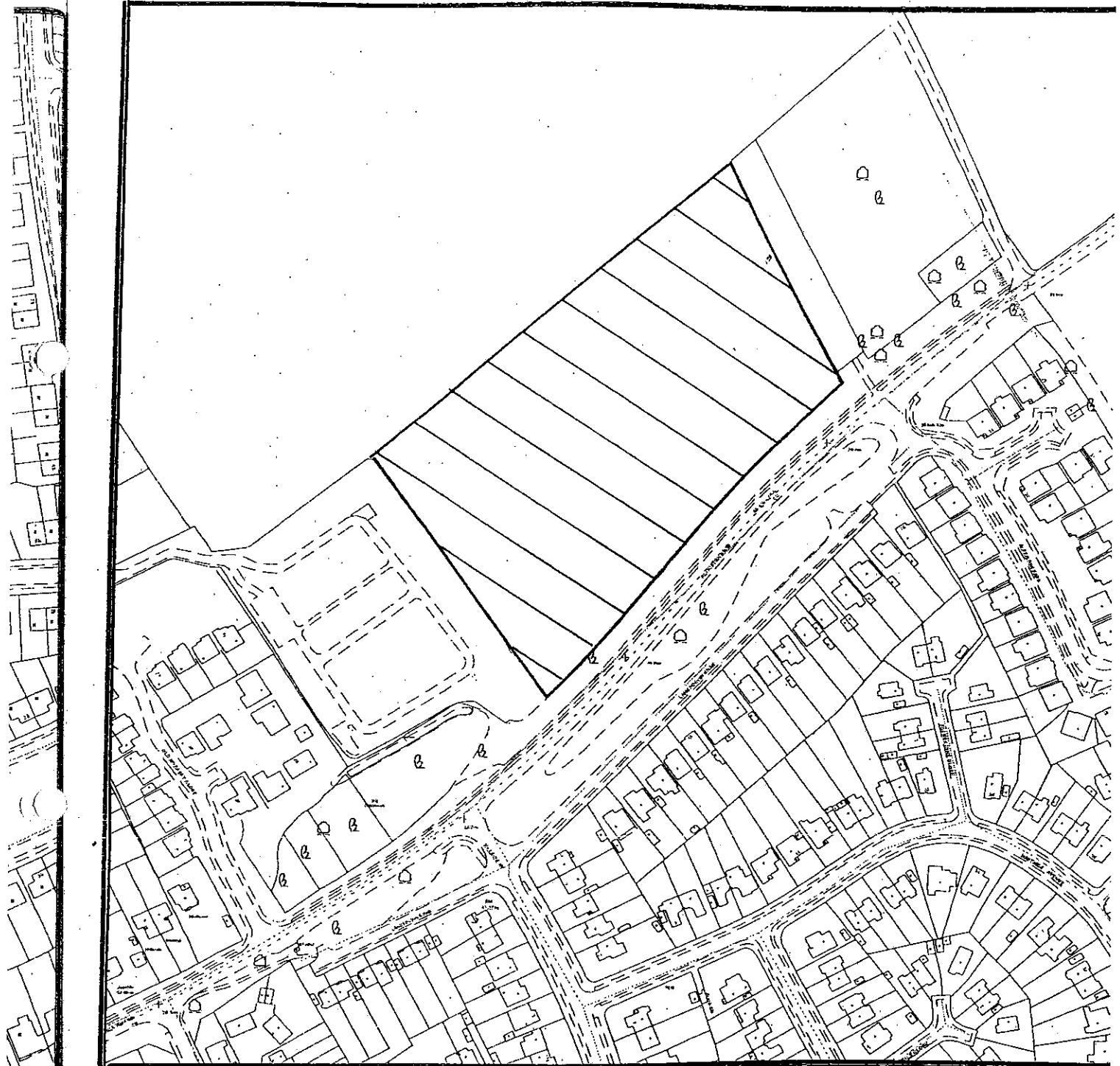

Lewes District Council
www.lewes.gov.uk

Estates & Valuation Services

BYELAWS PLEASURE GROUNDS & OPEN SPACES LAND OFF ALFRISTON ROAD SEAFORD

O.S. MAP REF:
TQ 4900 SE

DEED PACKET NO.:
955

SCALE:
1:2500



PLAN N
E 109/01

Reproduced from the Ordnance Survey map with the sanction of the Controller of H.M. Stationery Office. Crown Copyright reserved.

REV:

LDC. Plan No 29



Lewes District Council
www.lewes.gov.uk

Estates & Valuation Services

BYELAWS PLEASURE GROUNDS & OPEN SPACES THE BRICKFIELDS SEAFORD

O.S. MAP REF:
TV 4799 NW

DEED PACKET NO.:
971

SCALE:
1:1500



PLAN NO.:
E 110/03

Reproduced from the Ordnance Survey map with the sanction of the Controller of H.M. Stationery Office. Crown Copyright reserved.

REV:

LDC. Plan No 30



Lewes District Council
www.lewes.gov.uk

Estates & Valuation Services

BYELAWS PLEASURE GROUNDS & OPEN SPACES TELSCOMBE PLAYING FIELDS TELSCOMBE

O.S. MAP REF:
TQ 4200 NW/SW

DEED PACKET NO.:
834

SCALE:
1:3500



PLAN NO.:
E 111/03

Reproduced from the Ordnance Survey map with the sanction of the Controller of
H.M. Stationery Office. Crown Copyright reserved.

REV:

LDC. Plan No 31

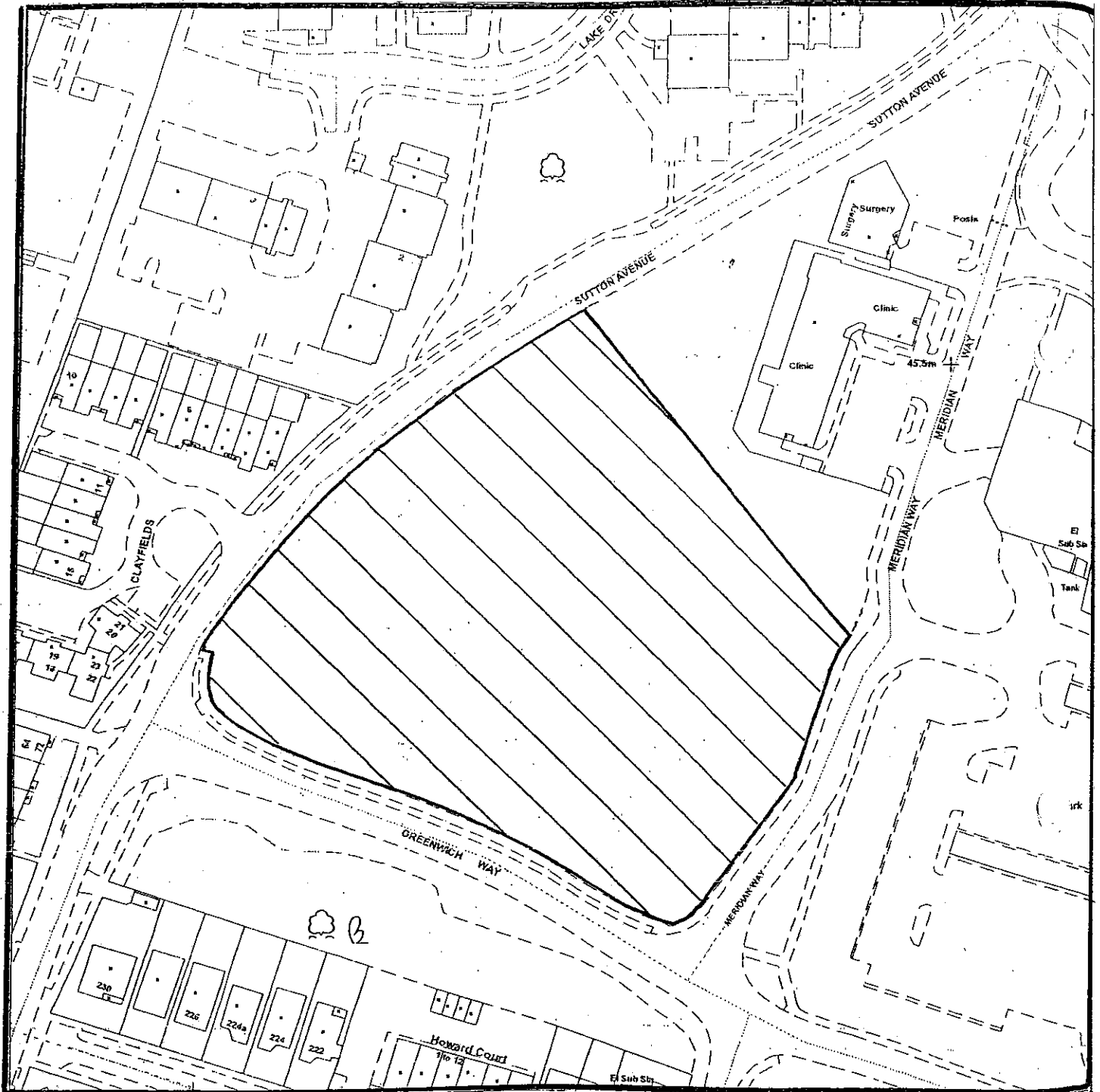

Estates & Valuation Services

BYELAWS PLEASURE GROUNDS & OPEN SPACES MERIDIAN PARK PEACEHAVEN

O.S. MAP REF:
TQ 4101 NE/SE

DEED PACKET NO.:
892

SCALE:
1:1250

PLAN NO.:
E 112/03

Reproduced from the Ordnance Survey map with the sanction of the Controller of H.M. Stationery Office. Crown Copyright reserved.

REV:

N



LDC. Plan No 32

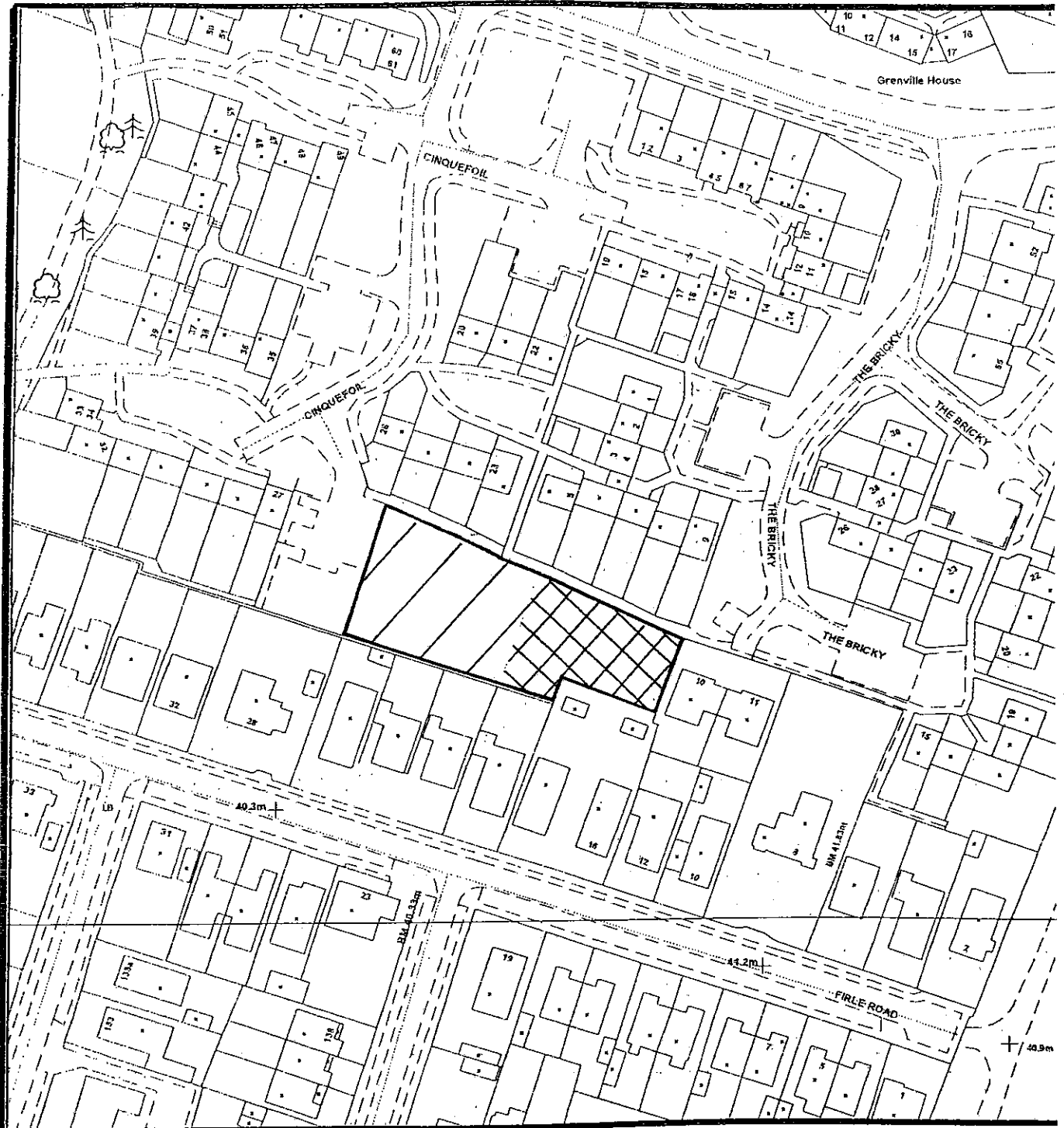

Estates & Valuation Services

BYELAWS PLEASURE GROUNDS & OPEN SPACES CINQUE FOIL PEACEHAVEN

O.S. MAP REF:
TQ 4101 NW

DEED PACKET NO.:
695

SCALE:
1:1250

Reproduced from the Ordnance Survey map with the sanction of the Controller of H.M. Stationery Office. Crown Copyright reserved.

N



PLAN N
E 113/0

REV:

LDC. Plan No 33

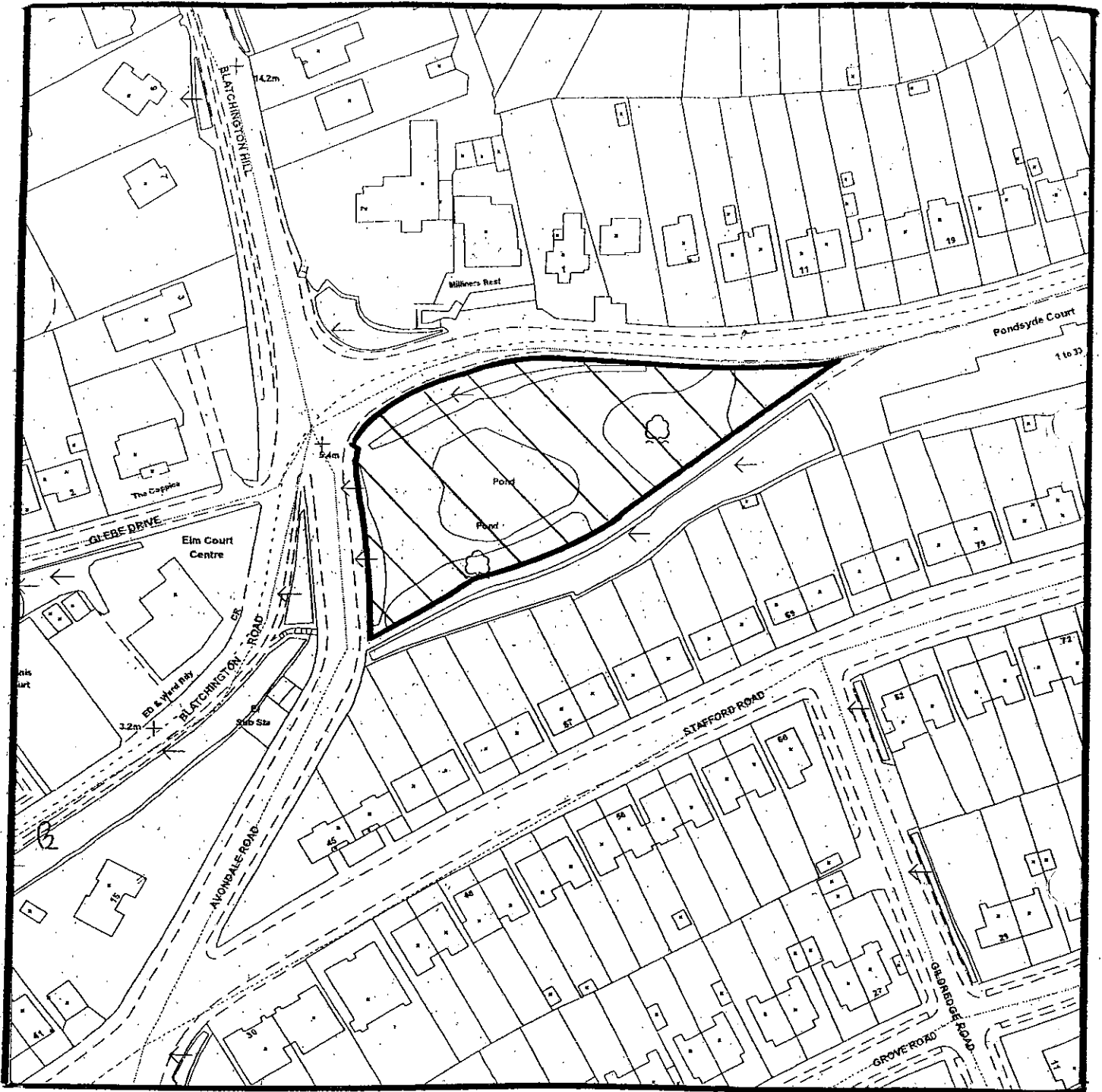

Lewes District Council
www.lewes.gov.uk

Estates & Valuation Services

BYELAWS PLEASURE GROUNDS & OPEN SPACES BLATCHING POND, SUTTON DROVE SEAFORD



O.S. MAP REF:
TV 4899

DEED PACKET NO.:

SCALE:
1:1250

PLAN NO.:
E 122/03

Reproduced from the Ordnance Survey map with the sanction of the Controller of H.M. Stationery Office. Crown Copyright reserved.

REV:

GIVEN under the COMMON SEAL of LEWES DISTRICT COUNCIL this *Sixteenth* day
of *September* 2003 in pursuance of a Resolution of the Council passed on the
Sixteenth day of *July* 2003

THE COMMON SEAL of LEWES)
DISTRICT COUNCIL was hereunto)
affixed in the presence of:)

Catherine Knison

District Solicitor

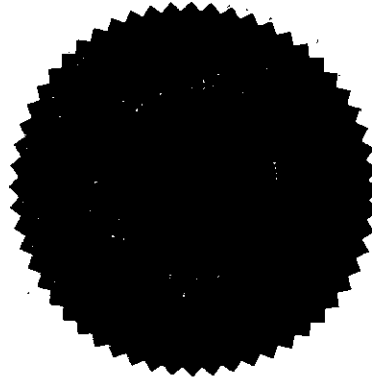

157/03

The foregoing byelaws are hereby confirmed by the Secretary of State and
shall come into operation on the fourteenth day of November 2003

Signed by authority of the Secretary of State

P. Rowsell

P Rowsell

Senior civil servant

in the Office of the Deputy Prime Minister

31 OCT 2003
LONDON, SW1E 5DU.

